

NEW TERMINAL BUILDING

WBS NO. 36237.25.15.1

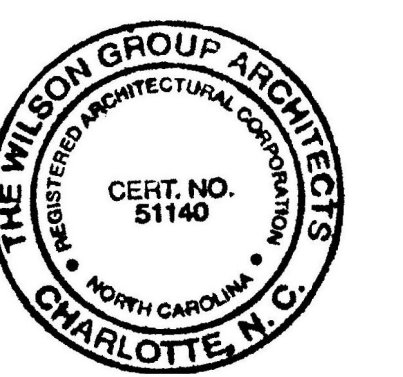

ARCHITECT
THE WILSON GROUP
 P O BOX 5510
 CHARLOTTE, NC 28229
 (704) 331-9747

PROJECT MANAGER | CIVIL ENGINEER
TALBERT & BRIGHT
 4810 SHELLEY DRIVE
 WILMINGTON, NC 28405
 (810) 783-5360
 FIRM NO.: C-0713

STRUCTURAL ENGINEER
STEWART
 101 N. TRYON ST., SUITE 1400
 CHARLOTTE, NC 28202
 (704) 909-3523
 FIRM NO.: C-1051

MECHANICAL, ELECTRICAL, PLUMBING & FIRE PROTECTION ENGINEER
SABER ENGINEERING
 2923 S. TRYON ST., SUITE 280
 CHARLOTTE, NC 28203
 (704) 373-0068
 FIRM NO.: C-2130

IT / SECURITY
VERTEX TECHNOLOGY CONSULTANTS
 4700 LEBANON RD. SUITE A-1
 CHARLOTTE, NC 28227
 (860) 272-8500

SF SUMMARY	
	AREA SF
FIRST LEVEL HSF	5,087 HSF
FIRST LEVEL PORCHES SF	843 UHSF
SECOND LEVEL HSF	1,948 HSF
SECOND LEVEL DECK SF	416 UHSF
TOTAL HSF	7,035 HSF

WALL LEGEND	
1 HR RATED WALL	-----
STUD WALL	=====
BRICK VENEER	
SHEAR WALL	=====

- NOTES
1. CEILING HEIGHT TO BE 10'-0" A.F.F. U.N.O.
 2. LIGHT FIXTURES AND SPEAKERS TO BE CENTERED WITHIN ROOMS, TYP. UNLESS NOTED OR SHOWN OTHERWISE. COORDINATE GRID LAYOUT WITH DEVICE LOCATIONS TYP.
 3. SEE FINISH SCHEDULE FOR ACOUSTICAL CEILING TYP. OF DESIGN. SEE SECTION DETAIL DRAWINGS FOR ADDITIONAL INFORMATION.

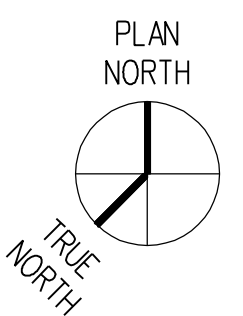
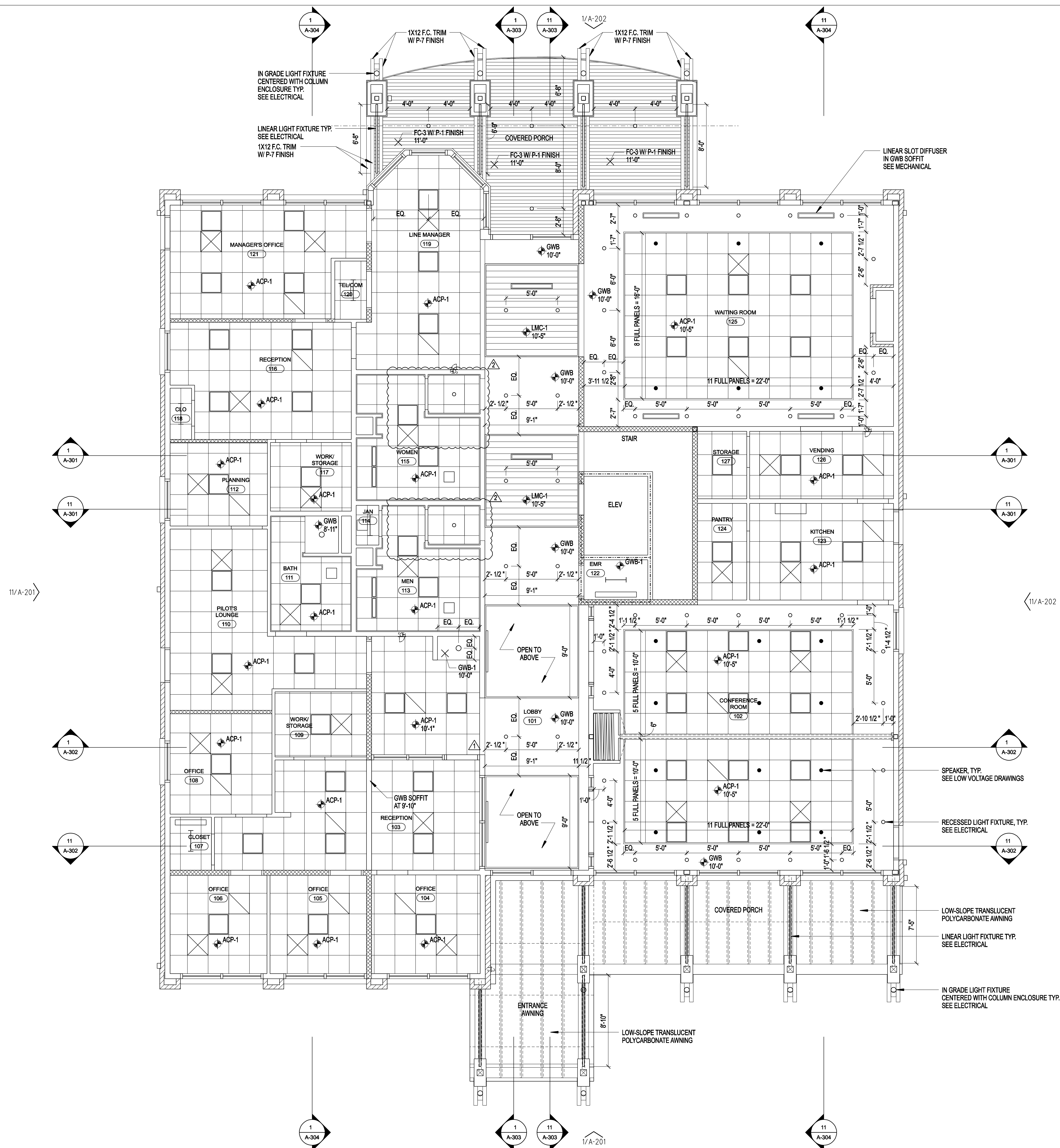

1/4"=1'-0"

- REVISIONS
- △ BD-05 - JUNE 19, 2023
 - △ BD-06 - JULY 10, 2023

DATE SEPTEMBER 9, 2022
 PROJECT NUMBER 9189-000

FIRST LEVEL REFLECTED CEILING PLAN

SHEET NUMBER

A-121