

## Harnett County Department of Public Health Improvement Permit

A building permit cannot be issued with only an Improvement Permit

ISSUED TO: Brad Cummings PROPERTY LOCATION: 1960 Spring Hill Church Rd (SR 1238)  
 SUBDIVISION \_\_\_\_\_ LOT # \_\_\_\_\_  
 NEW  REPAIR  EXPANSION  Site Improvements required prior to Construction Authorization Issuance: \_\_\_\_\_  
 Type of Structure: 20'x38' assembly hall addition  
 Proposed Wastewater System Type: pump to 25% reduction  
 Projected Daily Flow: 600 GPD  
 Number of bedrooms: \_\_\_\_\_ Number of Occupants: 200 max  
 Basement  Yes  No  
 Pump Required:  Yes  No  May be required based on final location and elevations of facilities  
 Type of Water Supply:  Community  Public  Well Distance from well \_\_\_\_\_ feet Permit valid for:  Five years  
 Permit conditions: \_\_\_\_\_  No expiration

Authorized State Agent: Mark A. REHS Date: 12-5-22 SEE ATTACHED SITE SKETCH  
 The issuance of this permit by the Health Department in no way guarantees the issuance of other permits. The permit holder is responsible for checking with appropriate governing bodies in meeting their requirements. This site is subject to revocation if the site plan, plat, or the intended use changes. The Improvement Permit shall not be affected by a change in ownership of the site. This permit is subject to compliance with the provisions of the Laws and Rules for Sewage Treatment and Disposal and to conditions of this permit.

### Construction Authorization (Required for Building Permit)

The construction and installation requirements of Rules .1950, .1952, .1954, .1955, .1956, .1957, .1958, and .1959 are incorporated by references into this permit and shall be met. Systems shall be installed in accordance with the attached system layout.

ISSUED TO: Brad Cummings PROPERTY LOCATION: 1960 Spring Hill Church Rd (SR 1238)  
 SUBDIVISION \_\_\_\_\_ LOT # \_\_\_\_\_  
 Facility Type: 20'x38' assembly hall add  New  Expansion  Repair  
 Basement?  Yes  No Basement Fixtures?  Yes  No  
 Type of Wastewater System\*\* pump to 25% reduction (Initial) Wastewater Flow: 600 GPD  
 (See note below, if applicable ) pump to 25% reduction (Repair)

**Installation Requirements/Conditions**

Septic Tank Size <u>1250</u> gallons	Number of trenches <u>1</u>	Trench Spacing: <u>9</u> Feet on Center
Pump Tank Size <u>1000</u> gallons	Exact length of each trench <u>375</u> feet	Soil Cover: <u>6</u> inches
	Trenches shall be installed on contour at a	(Maximum soil cover shall not exceed
	Maximum Trench Depth of: <u>18-22</u> inches	<u>36"</u> above the trench bottom)
	(Trench bottoms shall be level to +/-1/4"	
	in all directions)	

Pump Requirements: \_\_\_\_\_ ft. TDH vs. \_\_\_\_\_ GPM \_\_\_\_\_ inches below pipe  
 Aggregate Depth: \_\_\_\_\_ inches above pipe  
 Conditions: \_\_\_\_\_ inches total

**WATER LINES (INCLUDING IRRIGATION) MUST BE 10FT. FROM ANY PART OF SEPTIC SYSTEM OR REPAIR AREA.  
 NO UTILITIES ALLOWED IN INITIAL OR REPAIR DRAIN FIELD AREA.**

\*\*If applicable: I understand the system type specified is different from the type specified on the application. I accept the specifications of this permit.

Owner/Legal Representative Signature: \_\_\_\_\_ Date: \_\_\_\_\_

This Construction Authorization is subject to revocation if the site plan, plat, or the intended use changes. The Construction Authorization shall not be transferred when there is a change in ownership of the site. This Construction Authorization is subject to compliance with the provisions of the Laws and Rules for Sewage Treatment and Disposal and to the conditions of this permit. SEE ATTACHED SITE SKETCH

Authorized State Agent: Mark A. REHS Date: 12-5-22  
 Construction Authorization Expiration Date: ~~12-5-22~~ 12-5-27

MHO

# Harnett County Department of Public Health Site Sketch

Property Location: 19400 Spring Hill Church Rd (SR 1238)

Issued To: Brad Cummings Subdivision \_\_\_\_\_ Lot # \_\_\_\_\_

Authorized State Agent: Moh A REH Date: 12-5-22

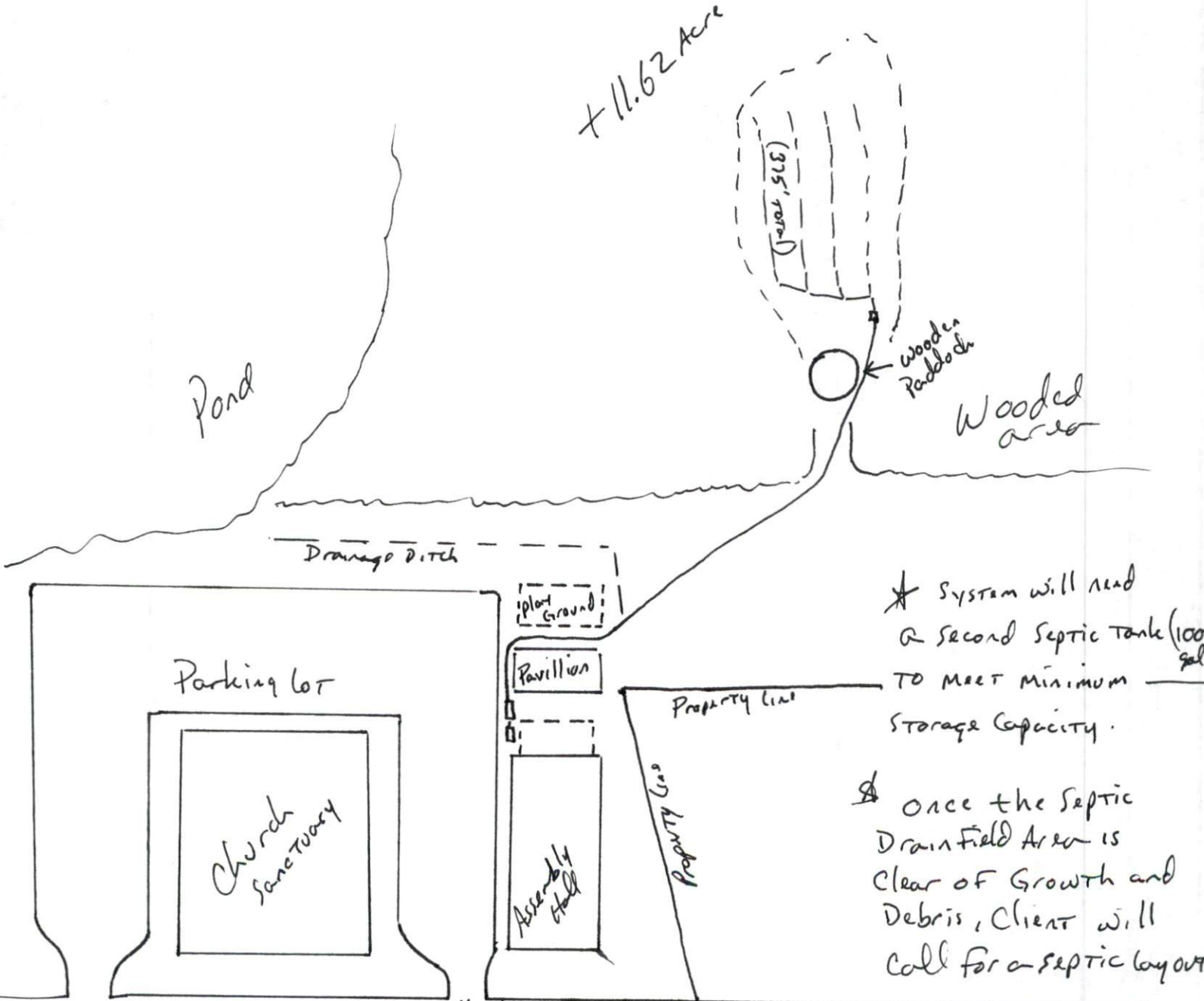

\* System will need  
a second septic tank (1000 gal)  
to meet minimum  
storage capacity.

\* Once the septic  
drain field area is  
clear of growth and  
debris, client will  
call for a septic layout

This drawing is for illustrative purposes only. Spring Hill Church Rd System installation must meet all pertinent laws, rules, and regulations.