

# PROOFROLLING OBSERVATION REPORT

**Report Number:** 70241180.0013  
**Service Date:** 01/21/26  
**Report Date:** 01/23/26  
**Task:** Soils-Concrete Testing



3150 Spring Forest Rd Ste 100  
Raleigh, NC 27616-2810  
919-873-2211 Reg No: F-0869

## Client

3D Community Church Inc  
Attn: Mel Manning  
658 Graham Road  
Sanford, NC 27332

## Project

3D Community Church  
658 Graham Road  
Sanford, NC 27332

Project Number: 70241180

## General Information

Brian Goldberg with Iwaly Grading Inc. requested Terracon to be on site to observe proofrolling as described in the table below. Work is being performed by Iwaly Grading Inc. The results of observation(s) for today were reported to Brian Goldberg with Iwaly grading inc.

## Equipment Used

Iwaly Grading Inc used a fully loaded (74,220 pound) dump truck to make multiple passes in a parallel pattern.

## Field Summary

Observed Location	Visual Subgrade Description & Elevation	Status
(1) Paving - Fire access road	Light brown sand - Final Soil Subgrade	Complies

## Observation Summary

Based on our observations, proofroll activities at the above-referenced locations appeared to be completed in accordance with project plans and specifications.

## Limitations

*As construction proceeds, the subgrade may be disturbed due to utility excavations, construction traffic, desiccation, or excessive wetting from inclement weather. As a result, the subgrade may not be suitable for construction and corrective action will be required. The subgrade should be re-evaluated prior to paving for signs of disturbance or excessive rutting. If disturbance/desiccation/excessive wetting has occurred, subgrade areas should be reworked in accordance with specifications and recommendations. Terracon should be contacted if conditions are not as described in our report.*

**Services:** Visual subgrade evaluations by proofrolling with a rubber-tired vehicle.

**Terracon Rep.:** Michael Waters

**Reported To:** Brian Goldberg with Iwaly grading inc

**Contractor:** Iwaly Grading Inc

### Report Distribution:

(1) 3D Community Church Inc, Mel Manning

(1) Ecclesia Construction Company LLC, Jeff Moore

### Reviewed By:

rvw2: cvn

Alex Bullard  
Project Manager

The tests were performed in general accordance with applicable ASTM, AASHTO, or DOT test methods. This report is exclusively for the use of the client indicated above and shall not be reproduced except in full without the written consent of our company. Test results transmitted herein are only applicable to the actual samples tested at the location(s) referenced and are not necessarily indicative of the properties of other apparently similar or identical materials.

**Photo Log**

**Report Number:** 70241180.0013  
**Service Date:** 01/21/26  
**Report Date:** 01/23/26  
**Task:** Soils-Concrete Testing



3150 Spring Forest Rd Ste 100  
Raleigh, NC 27616-2810  
919-873-2211 Reg No: F-0869



(P1) Overall area



(P2) Proofroll in progress

# Photo Log

**Report Number:** 70241180.0013  
**Service Date:** 01/21/26  
**Report Date:** 01/23/26  
**Task:** Soils-Concrete Testing



3150 Spring Forest Rd Ste 100  
Raleigh, NC 27616-2810  
919-873-2211 Reg No: F-0869

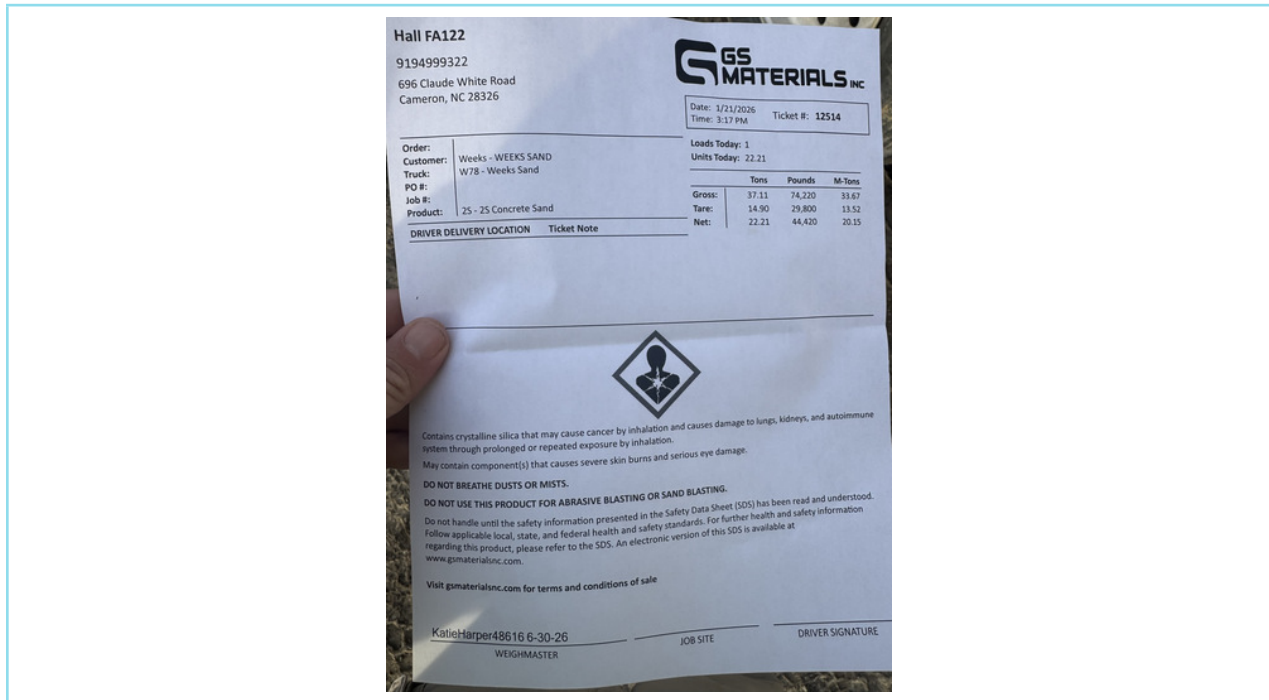

(P3) Truck load ticket

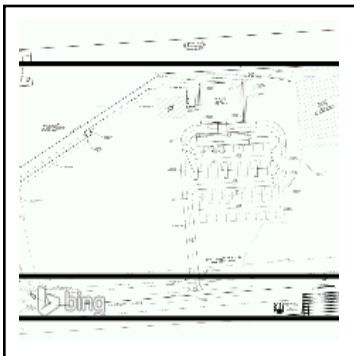
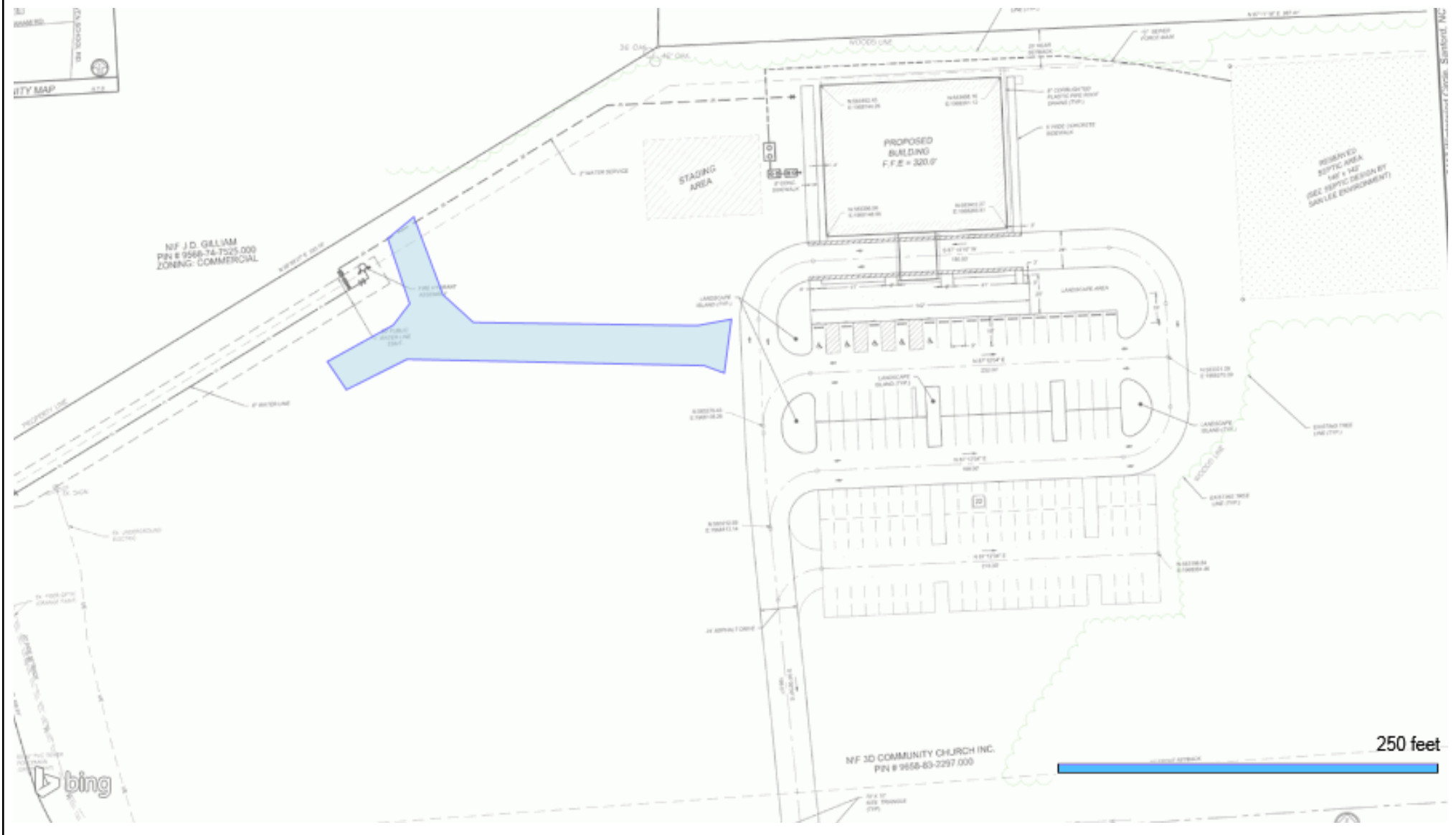

- Test
- ▲ Retested / Accepted
- ▲ ■ Deviation

  
 3150 Spring Forest Rd    Raleigh, NC 27616-2810  
 Ste 100  
 919-873-2211    terracon.com

<b>3D Community Church</b>
Proofrolling Observation

Exhibit
<b>A-1</b>

Report Number: 70241180.0013	Service Date: 01/21/2026	Employee: Waters II, Michael	Scale: Refer to Drawing
---------------------------------	-----------------------------	---------------------------------	----------------------------