

KEY	QTY.	ITEM NAME	MANUFACTURER	MODEL NUMBER	SUPPLIER	POWER REQUIRED	PLUMBING REQUIRED	MISC. NOTES
1	1	6 MEAT CASE	HOWARD MCCRAY	SC-CDS34N-6-JML	ECO	8.7AMP 115V/60/1 (POWER LEFT SIDE OF UNIT)		NSF-7. OUTLET INSTALLED AT 18" AFF
1A	0	4 MEAT CASE	HOWARD MCCRAY	SC-CDS34N-4-JM	ECO	6 AMP 115V/60/1		NSF-7. OUTLET INSTALLED AT 18" AFF
2	1	SNEEZEGUARD	C.R. LAURENCE		GC			C.R. LAURENCE 323-588-1281 X 7710 RICARDO BASULTO
3	1	4' DROP IN COLD UNIT	DELFIELD	JM-8148-EFNP	ECO	7.5 AMP 115V/115V/60/V		NO DRAIN REQUIRED. OUTLET INSTALLED AT 18" AFF
3A	1	2' DROP IN COLD UNIT	DELFIELD	N8118-EF	ECO	7.5 AMP 115V/115V/60/V		NO DRAIN REQUIRED. OUTLET INSTALLED AT 18" AFF
4	2	SLICER	BIZERBA	JM-GSP-H33 W/LIFT	ECO	120V/ 60/ 1PH		OUTLET INSTALLED AT 24" AFF, IN MILLWORK
5	1	MENU BOARD	JMFS		GRAPHICS CO.			ORDERED WITH GRAPHICS PACKAGE
6	0	TELEPHONE	VARIES	VARIES	FRANCHISEE			2 LINE PHONE. OUTLET INSTALLED AT 42" AFF
7	3	CHIP DISPLAY UNIT	PEPSI					
8	1	CASH REGISTER	INFOSOFT	UP700	FRANCHISEE			
9								
10	1	BREAD OVEN	NUVU	JM-QB 5/10 AUTOMIST	ECO	29AMP 208V/3ph	1/4" SUPPLY LINE	AUTO MISTER NOT OPTIONAL. OUTLET INSTALLED AT 78" AFF
11	T.B.D.	BREAD PANS	WINCO	ALXP1826	SMALLWARES CO.			18 GAUGE SHEET PANS
12	4	BREAD RACK	CHANNEL	401AC	SMALLWARES CO.			W/ (2) CURTAIN COVERS, WINDOW DISPLAY, ZIPPER
12A	0	BREAD RACK (STATIONARY)	CHANNEL	DE100517	SMALLWARES CO.			W/ (2) CURTAIN COVERS, WINDOW DISPLAY, ZIPPER
13	3	HAND SINK - WALL HUNG	COMPONENT HARDWARE GROUP	JM-FS17D141005JM	ECO		C.H.G. FAUCET FS17D141005JM WITH DRAIN BASKET (WATER-SEWER LINES)	WALL MOUNT HAND SINK W/ TWO 7/8" SIDE SPLASHES AND FAUCET
14	1	3 COMPARTMENT SINK	ADVANCE TABCO/C.H.G.	JM-FC-3JM-DBS-BS-CUS.	ECO		C.H.G. KL53-1000-AF4 PRE-RINCE SPRAYER/ ADD-A-FAUCET. KL54-8012 FAUCET AND D50-7100 LEVER WASTES - QTY 3	IF TALLER THAN 9", END SPLASHES ARE REQUIRED
15	1	S.S. WORKTABLE-PREP SINK	ADVANCE TABCO/C.H.G.	JM-TKMS-5JM-11BRSL	ECO		C.H.G. JM-KL54-8002 FAUCET (5" SWIVEL GOOSENECK SPOUT)	ONE COMPARTMENT SINK WITH DRAIN BOARD ON THE LEFT SIDE
15A	0	PREP SINK	ADVANCE TABCO/CHG	FC-1JM18-D	ECO		CHG KL54-8002 FAUCET	ONE COMPARTMENT SINK WITH DRAIN BOARD ON EITHER THE LEFT OR RIGHT SIDE
16	VARIES	WIRE SHELVING	METRO		ECO			2 TIER WALL SHELVES OVER SINKS & S/S TABLES. 4 TIER COOLER/FREEZER SHELVING & DRY STORAGE. ALL WALL BLOCKING IS REQUIRED FOR INSTALLATION OF WALL MOUNTED SHELVING.
17	1	1 DOOR PEPSI COOLER	PEPSI	GDM-26	PEPSI			OUTLET INSTALLED AT 18" AFF
17A	0	2 DOOR PEPSI COOLER	PEPSI	GDM-47	PEPSI			OUTLET INSTALLED AT 18" AFF
18	1	WALK-IN COOLER (6' W X 8' D)	NOR-LAKE	JM7S-72X96-J-36-CP	ECO	115V FOR LIGHTS AND DOOR HEATER, 15 AMP BREAKER		FLOORLESS, CLOSE COUPLED SYSTEM. FIELD COORDINATE POWER REQUIREMENT
18A	1	REMOTE REFRIG. SYSTEM	NOR-LAKE	NAWJ5ORLO-#BQ-25	ECO			REFER TO MANUFACTURERS INFO.
19	1	WALK-IN FREEZER (6' W X 4' D)	NOR-LAKE	JMF777-72X48-J-36-CP	ECO	115V FOR LIGHTS AND DOOR HEATER, 15 AMP BREAKER		WITH 4" STEP-UP FLOOR PANEL, CLOSE COUPLED SYSTEM. FIELD COORDINATE POWER REQUIREMENT
19A	1	CAPSUL PACK	NOR-LAKE	CPF-100JC-S-4-EV	ECO	CONDENSING UNIT - 208-230/ 60/1, RLA 6.1, MCA 9, 15A MAX FUSE EVAPORATOR UNIT - 208-230/ 60/1, MCA 9, 15A MAX FUSE		WILL INCLUDE PIGTAIL FOR SINGLE PORT CONNECTION - MUST BE HARDWIRED
20	1	MOP SINK	EXIST CLEAN & REUSE	2X2'	GC		1/2" SUPPLY 1 1/2" DRAIN, VENT	MOP HANGER AND WALL GUARD
21A	2	MEGATOP SANDWICH UNIT	DELFIELD	JM-D4427N-12M-JM3	ECO	115V/60/1 PH - 3.3. AMPS-STANDARD		W/CASTERS AND COVER ENHANCEMENT. OUTLET INSTALLED AT 18" AFF
21B	0	REFRIGERATED WORK TOP	HOSHIZAKI	WR60A-D4	ECO	115V/60/1PH - 3.3 AMPS-STANDARD		HS-4007 DRAWER ASMY. DIVIDER BAR (4 S.S. DRAWER)
22	1	RANGE WITH 4" GRILL	IMPERIAL	IR-G48T-XB-JM11	ECO		1 - KROWNE JM-M7548K GAS CONN. CONFIRM NATURAL OR LP GAS	OPTION: CASTER, FLEX GAS HOSE, QUICK CONNECT & RESTRAINING DEVICE. BE SURE TO INCLUDE PERFORMANCE CHECK
23	1	EXHAUST HOOD SYSTEM & FIRE SYSTEM FOR GRILL	CAPTIVE AIRE	JM-HOOD SPECS.	ECO	(4) 115V (SEE BELOW)		FIRE SYSTEM ANSUL
23.1	1	GRILL HOOD	CAPTIVE AIRE	JM-5424ND-2-PSF-F(6)	ECO	(1) 115V		SHOP DRAWINGS ARE REQUIRED. CONTACT: DAVID.LONG@CAPTIVEAIRE.COM AND REG32NA@CAPTIVEAIRE.COM
23.2	1	EXHAUST FAN FOR GRILL	CAPTIVE AIRE	JM-DU50HFA	ECO	(1) 115V/60HZ/1 PH - 500 HP		SHOP DRAWINGS ARE REQUIRED. CONTACT: DAVID.LONG@CAPTIVEAIRE.COM AND REG32NA@CAPTIVEAIRE.COM
23.3	1	TEMPERED AIR SUPPLY FAN	CAPTIVE AIRE	JM-D-76	ECO	(1) 115V/60HZ/1 PH - 1.00 HP		SHOP DRAWINGS ARE REQUIRED. CONTACT: DAVID.LONG@CAPTIVEAIRE.COM AND REG32NA@CAPTIVEAIRE.COM
23.4	1	FIRE SUPPRESSION SYSTEM	CAPTIVE AIRE	JM-ANSUL 6 GALLON	ECO			MECHANICAL SHUT-OFF VALVE (ANSUL)
23.5	1	ELECTRICAL PACKAGE	CAPTIVE AIRE	JM-SC-111110FP	ECO			SHOP DRAWINGS ARE REQUIRED. CONTACT: DAVID.LONG@CAPTIVEAIRE.COM AND REG32NA@CAPTIVEAIRE.COM
23A	1	CONDENSATE HOOD FOR BREAD OVEN (5'X3')	CAPTIVE AIRE	6024VHB-ND	ECO			SHOP DRAWINGS ARE REQUIRED. CONTACT: DAVID.LONG@CAPTIVEAIRE.COM AND REG32NA@CAPTIVEAIRE.COM
23B	1	EXHAUST FAN FOR BREAD OVEN	CAPTIVE AIRE	JM-DU12HFA	ECO	(1) 115V/60HZ/1 PH - 180 HP		SAME INFO. SEE ABOVE
24	0	T.V.'S W/ MOUNTING BRACKETS	VARIES	42" MONITOR	FRANCHISEE/ GC	110 VOLT		OUTLET AT 102" AFF, WALL BRACKETS REQUIRED.
25	4	PORTABLE FIRE EXTINGUISHERS			GC			WALL MOUNTED
26	1	DRINK DISPENSER & ADAPTER KIT	PEPSI	DISPENSER: IDC255, ADAPTOR: 80002957	PEPSI	9.3 AMP 115V/60/1	1/2" SUPPLY, CONDENSATION DRAIN	COORDINATE W/ PEPSI. OUTLET INSTALLED AT 42" AFF
27	0	FLOOR SAFE	VARIES		FRANCHISEE			
28	1	ICED TEA BREWER/DISPENSER	BUNN	TB3Q	LUZIANNE	120V, 14.4 AMP		1-800-627-2094. OUTLET INSTALLED AT 42" AFF
29	0	DELFIELD MEAT/CHEESE CASE	DELFIELD	2FP36	ECO	7.5 AMP 115V/60/1		NO DRAIN REQUIRED. NEMA NO. 5-15 PLUG AT 18" AFF. VERIFY SIZE
30A	0	S.S. TABLE 24" X "	ADVANCE TABCO	KMG-24 -JM	ECO			VERIFY SIZE
30B	0	BACK LINE PREP TABLE	ADVANCE TABCO	TKMS-368	ECO			VERIFY SIZE
30C	0	S.S. TABLE 30" X 30"	ADVANCE TABCO	KMS-300-JM	ECO			VERIFY SIZE
30D	0	S.S. TABLE 24" X "	ADVANCE TABCO	KMG-24 -JM	ECO			VERIFY SIZE
31	1	COUNTER TOP FOOD WARMER	VOLLRATH	71001 MODEL 1001	SMALLWARES CO.	120V, 5.8 AMP		OUTLET INSTALLED AT 54" AFF
31B	1	RECESSED BACON WARMER	MARSHALL	CZ3N-1	FIVE KIDS GROUP	120V, 3.5 AMP		NO DRAIN. 1/2" CORD WITH NEMA 5-15 PLUG. OUTLET INSTALLED AT 18" AFF
32	1	COUNTER SCALE	CAS	ED-30	ECO		AC ADAPTER DC 12V/1A OR 12V/2000mA, INTERNAL RECHARGEABLE SEALED ACID BATTERY - 6V DC	SITS ON TOP OF AND POWERS INTO THE MEAT CASE
33	0	UNDER COUNTER DRAWERED REF.	HOSHIZAKI	JM-UR27A-D2	ECO			OUTLET INSTALLED AT 18" AFF
33A	1	UNDER COUNTER REF.	HOSHIZAKI	HR24B	ECO	1.15 AMP 115V/60/1. 5-15P		NEMA 5-15P OUTLET INSTALLED AT 18" AFF
34	1	BAG IN BOX SYSTEM	PEPSI	PEPSI	PEPSI	110 / 120V - 20 AMP DUAL OUTLET	1/2" SUPPLY	WATER CONNECTION IS NEEDED FOR THE FILTRATION SYSTEM. OUTLET CAN BE INSTALLED AT 80" AFF. STAINLESS STEEL FINISH
35	1	REFUSE CONTAINER	ALPINE	470-65L	SMALLWARES CO.			
35A	2	SLIM JIM REFUSE CONTAINER	RUBBERMAID	11" X 20"	FIVE KIDS GROUP			
36	VARIES	TABLE TOPS	ATS	24" X 20"	FIVE KIDS GROUP			
36A	VARIES	TABLE TOPS	ATS	24" X 24"	FIVE KIDS GROUP			
37	VARIES	TABLE TOPS	ATS	24" X 45"	FIVE KIDS GROUP			
38	VARIES	BAR COUNTER	GC		GC			
39	VARIES	COMMUNITY TABLE	GC	30" X 109"	GC			
40	VARIES	TABLE BASES - HIGH	ATS	BLACK CRINKLE	FIVE KIDS GROUP			
41	VARIES	TABLE BASES - LOW	ATS	BLACK CRINKLE	FIVE KIDS GROUP			
42	VARIES	CHAIRS - HIGH	ATS		FIVE KIDS GROUP			
43	VARIES	CHAIRS - LOW	ATS		FIVE KIDS GROUP			
44	VARIES	BANQUETTE SEATING	GC		GC			
45	2	TANKLESS - WATER HEATERS	GC		GC			SEE FURNITURE DETAIL. BUILD ON SITE
46	1	ICE MAKER	HOSHIZAKI	JM-KM-520MAJ	ECO	115V/60/1 PH - 20 AMP BREAKER	PROVIDE DRAIN	OUTLET INSTALLED AT 42" AFF
47	1	PICK UP TOWER	METRO		ECO			CUSTOM METRO SHELVING 63"H, 24"D, 24"L
48								
49	2	JUICE SHELVING	METRO		FIVE KIDS GROUP			METRO SHELVING 7"H, 12"D, 42"L
49A	2	JUICE CRATES	JMFS		FIVE KIDS GROUP			
50	VARIES	STANCHIONS	VISIONTRON	VS301 (BLACK)	FIVE KIDS GROUP			WWW.CROWDCONTROLWAREHOUSE.COM. SINGLE LINE 7-5' 770-977-5774 / 4 UNITS INSTALLED IN DINING ROOM & 1 UNIT IN EACH RESTROOM
51	6	CEILING MOUNTED SPEAKERS			SOURCE 1 DISTRIBUTORS			24" LONG X 4" WIDE TROUGH WITH SIDE SQUEEGE ATTACHMENT
52	2	TROUGH	FRANKLEN SHEET METAL	26				
53	0	BABY CHANGING TABLE			SMALLWARES CO.			TO BE INSTALLED IN WOMENS RESTROOM
54	0	LOCKERS	QUALSERV	DD006402	ECO			TYPICALLY ORDERED WHEN REQ'D BY HD
55	0	AIR CURTAIN	BERNER	CHC10-1036AA	ECO	(1) 120V		OUTLET CAN BE INSTALLED AT 80" AFF.

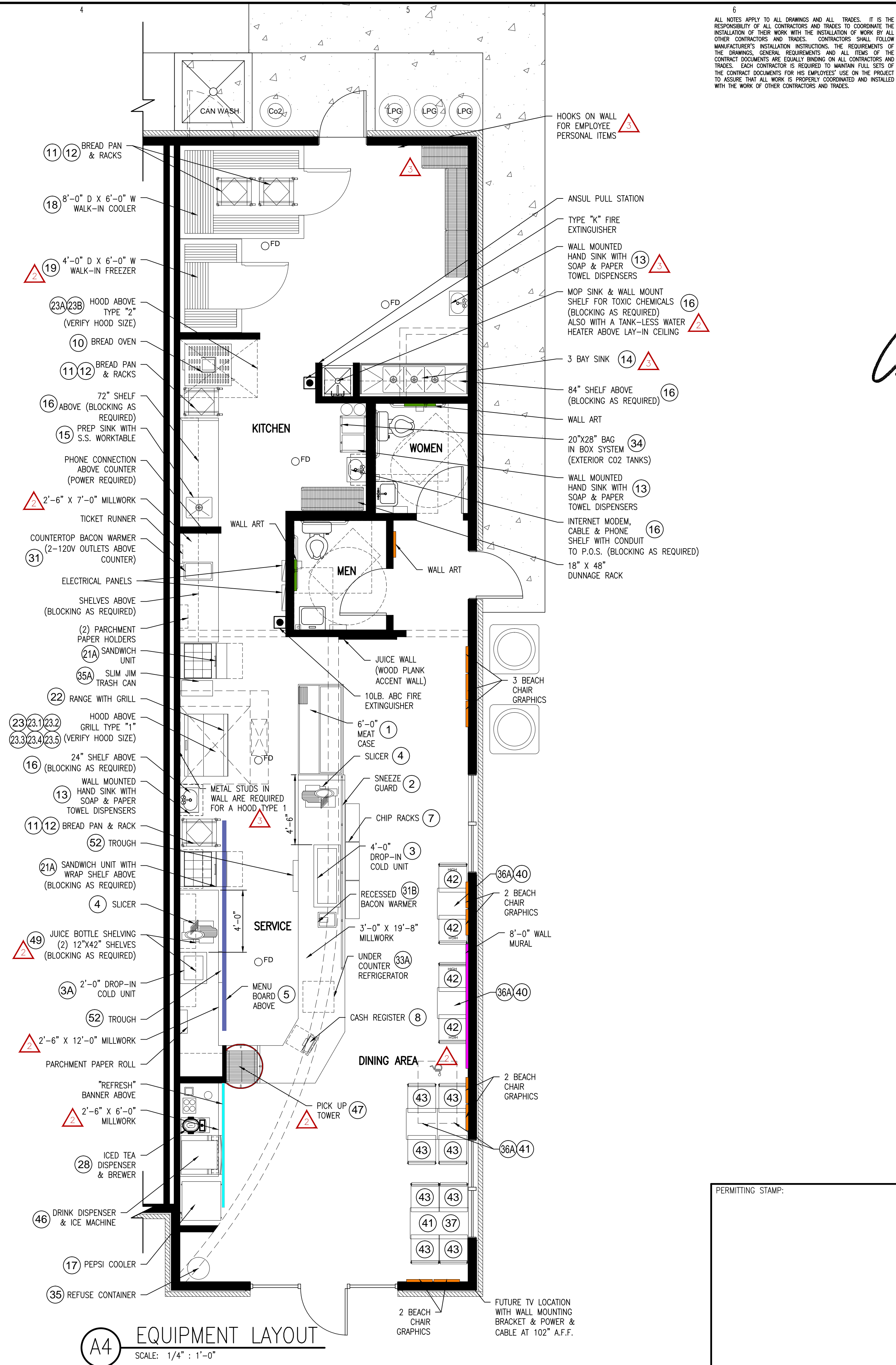

ALL NOTES APPLY TO ALL DRAWINGS AND ALL TRADES. IT IS THE RESPONSIBILITY OF ALL CONTRACTORS AND TRADES TO COORDINATE THE INSTALLATION OF THEIR WORK WITH THE INSTALLATION OF WORK BY ALL OTHER CONTRACTORS AND TRADES. CONTRACTORS SHALL FOLLOW MANUFACTURER'S INSTALLATION INSTRUCTIONS. THE REQUIREMENTS OF THE DRAWINGS, GENERAL REQUIREMENTS AND ALL ITEMS OF THE CONTRACT DOCUMENTS ARE EQUALLY BINDING ON ALL CONTRACTORS AND TRADES. EACH CONTRACTOR IS REQUIRED TO MAINTAIN FULL SETS OF THE CONTRACT DOCUMENTS FOR HIS EMPLOYEES' USE ON THE PROJECT TO ASSURE THAT ALL WORK IS PROPERLY COORDINATED AND INSTALLED WITH THE WORK OF OTHER CONTRACTORS AND TRADES.

Designed to Build
A Smaller Approach

ANDREW W. PRIVETTE, AIA
1920 FT. BRAGG ROAD
FAYETTEVILLE,
NORTH CAROLINA 28303
TELE. (910) 485-8567
andy@designedtobuild.com

Professional seal and signature of Andrew W. Privette, AIA, dated 12/22/21.

Jersey Mike's Subs
1624 NC 24-87 HIGHWAY
CAMERON, NORTH CAROLINA 28326

NO.	DATE	DESCRIPTION	BY	CHK

JOB CODE: 21JERSEY MIKES-CAMERON
DRAWN BY: S.S.TOPE
CHECKED BY: A. PRIVETTE
COPYRIGHT: DESIGNED TO BUILD

SHEET TITLE:
EQUIPMENT PLAN
UPDATED 1-25-2022

A-103
SHEET 3 OF 10

EACH CONTRACTOR IS REQUIRED TO INCLUDE ALL MINOR ITEMS, WHETHER OR NOT SHOWN ON PLANS, AS REQUIRED BY CODE AND FOR WORKING SYSTEMS, IN INITIAL COST OF WORK, AND AT NO ADDITIONAL COST TO THE OWNER. ANY DEVIATIONS FROM THESE DRAWINGS AND SPECIFICATIONS BY THE OWNER OR CONTRACTOR MUST BE APPROVED BY THE ARCHITECT IN WRITING AND PRIOR TO CONSTRUCTION. COPYRIGHT © ALL RIGHTS RESERVED BY DESIGNED TO BUILD. NOT TO BE COPIED OR REPRODUCED WITHOUT WRITTEN PERMISSION.