

AA TAKLA ENGINEERING, PLLC

Consulting. Design. Efficiency.

Atef A. Takla, PE | 919-358-1758 | atefakla@taklaengr.com

NC Firm License No. P-1446
418 Vivaldi Dr. Durham, NC 27712

Project: Providence Creek Amenity
Location: Center & Pool, Fuquay-Varina
Date: 6/25/24
Company: Poythress
Care Of: Juan

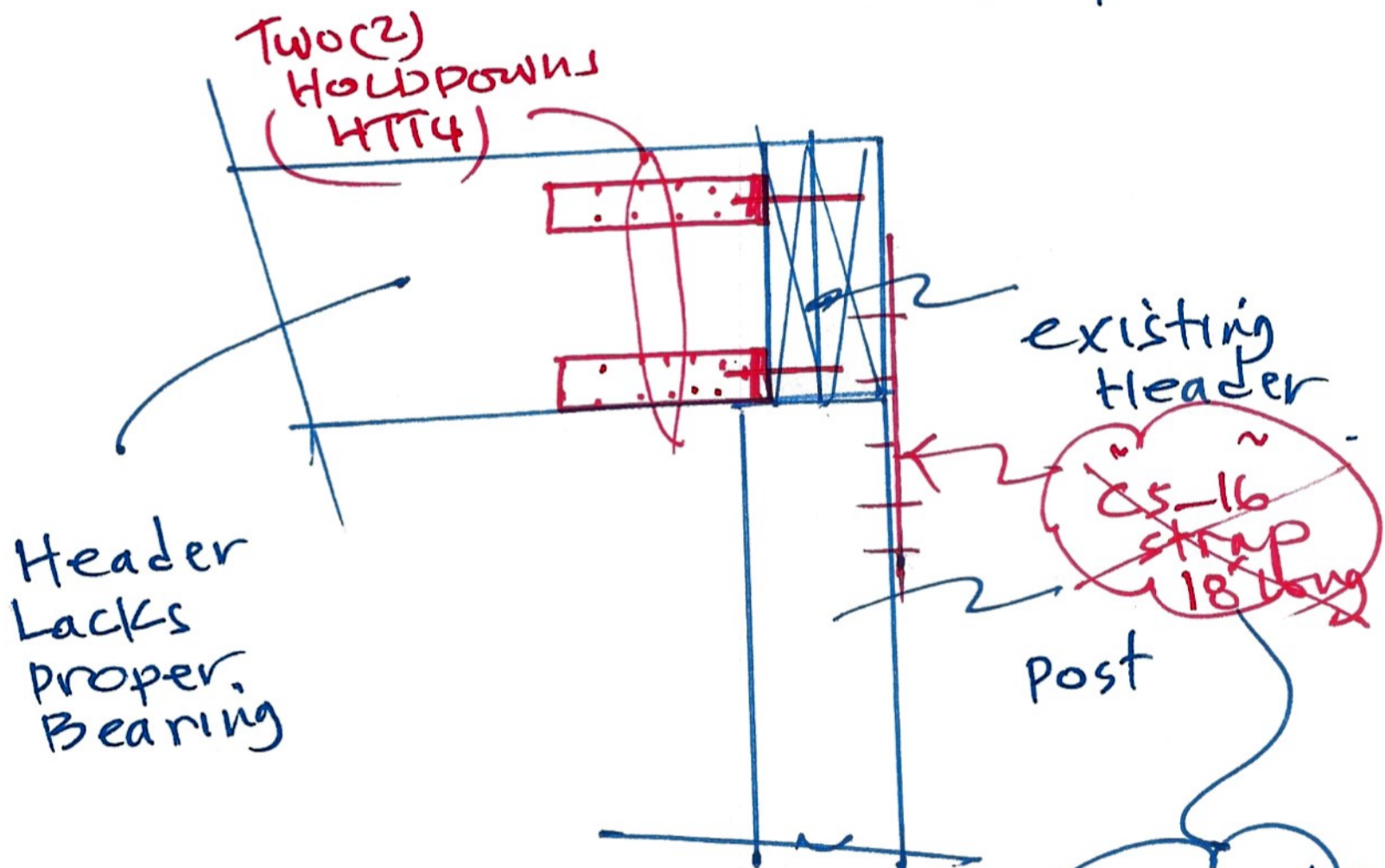
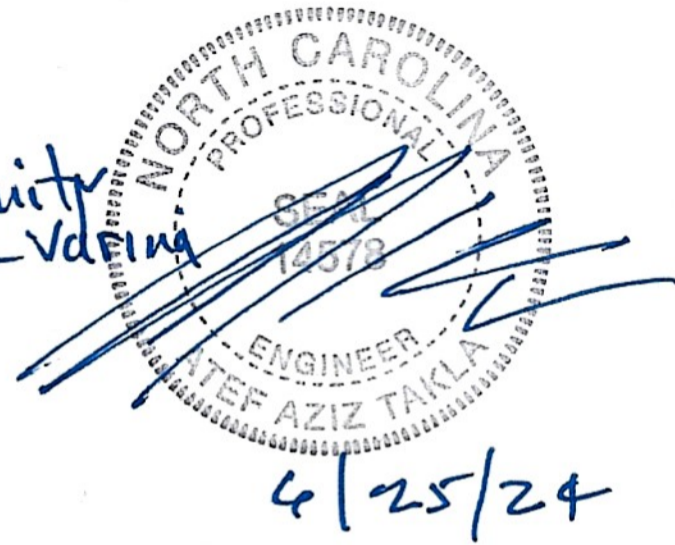

Sketch #2

no need for the strap
Existing uplift connection is adequate

Limitations of Inspection: Services provided are in accordance with the standard of practice for structural engineering and within the limits imposed by scope, schedule and budget. The determinations contained in this report are based on conditions observed at the time of the evaluation. No guarantees or warranties, expressed or implied, under this Agreement or otherwise, shall be construed in connection with services provided. Sequencing, shoring, means and methods of construction are considered beyond the scope of this report.