

GENERAL NOTES

1. ALL CONSTRUCTION, WORKMANSHIP, AND MATERIALS SHALL CONFORM TO THE LATEST REQUIREMENTS OF THE NORTH CAROLINA BUILDING CODE AND LOCAL REGULATIONS.
2. THE ENGINEER WHOSE SEAL APPEARS ON THESE DRAWINGS IS THE STRUCTURAL ENGINEER OF RECORD FOR THIS PROJECT. NO OTHER PARTY MAY MODIFY OR REUSE THESE CONSTRUCTION DOCUMENTS WITHOUT WRITTEN PERMISSION FROM WOODARD SEASE & ASSOCIATES, P.C. OR STRUCTURAL ENGINEERS WITHOUT DIMENSIONAL ACCURACY OF THE ARCHITECTURAL LAYOUT.
3. THE ENGINEER SHALL HAVE NO LIABILITY TO OTHERS FOR ACTS OR OMISSIONS OF THE CONTRACTOR/BUILDER OR ANY OTHERS PERFORMING WORK ON THIS PROJECT. THE ENGINEER IS NOT RESPONSIBLE FOR CONSTRUCTION REQUIREMENTS, METHODS, OR TECHNIQUES AND/OR SAFETY REQUIREMENTS TO ENSURE THAT THE CONSTRUCTION OF THIS STRUCTURE.
4. THE CONTRACTOR ASSUMES ALL RESPONSIBILITY FROM DEPICTED OR IMPLIED INFORMATION IN CONNECTION WITH THE CONSTRUCTION OF THIS STRUCTURE.
5. ONLY SEALED DRAWINGS ARE APPLICABLE FOR CONSTRUCTION.
6. DEFLECTION: FLOOR: L/360; ATTIC W/ CEILING: L/240; ROOF: L/180 - MORE STRINGENT CRITERIA MAY BE NOTED AT ENGINEER'S DISCRETION OR AS REQUESTED.
7. DO NOT SCALE DRAWINGS. CONTRACTOR SHALL CONTACT ARCHITECT FOR ITEMS NOT DIMENSIONED.
8. THE CONTRACTOR SHALL PROVIDE TEMPORARY BRACING AND SHORING OF ALL STRUCTURAL MEMBERS AS REQUIRED FOR THE STABILITY OF THE STRUCTURE DURING ALL PHASES OF CONSTRUCTION.
9. THE CONTRACTOR SHALL IMMEDIATELY NOTIFY THE ARCHITECT/ENGINEER OF ANY CONDITION WHICH, IN HIS OPINION, MIGHT ENDANGER THE STABILITY OF THE STRUCTURE OR CAUSE DISTRESS WITHIN THE STRUCTURE.
10. SEE ARCHITECTURAL, MECHANICAL, AND ELECTRICAL DRAWINGS FOR MISCELLANEOUS STEEL ITEMS NOT SHOWN.
11. COORDINATE SIZES AND LOCATIONS OF OPENINGS IN FLOORS AND ROOF WITH ARCHITECTURAL, MECHANICAL, AND ELECTRICAL REQUIREMENTS.
12. FOR ACTUAL ELEVATION OF FIRST FLOOR (REF. ELEV. 0'-0"), SEE SITE PLAN.
13. SUBMIT WRITTEN REQUEST TO THE ARCHITECT FOR APPROVAL OF ANY PROPOSED CHANGE TO THE REQUIREMENTS OF THE CONTRACT. SPlicing, CUTTING, NOTCHING OR OTHER ALTERATIONS TO THE STRUCTURAL MEMBERS ARE NOT PERMITTED WITHOUT WRITTEN AUTHORIZATION OF THE ENGINEER. ANY UNAUTHORIZED DEVIATION FROM THE CONTRACT DOCUMENTS, AND CORRECTION THEREOF, IS THE RESPONSIBILITY OF THE CONTRACTOR.
14. THE MOST STRINGENT REQUIREMENTS APPLY IN CASE OF CONFLICT BETWEEN SPECIFICATIONS, STANDARDS, CODES, AND DRAWINGS.



 09/16/2021

 Reviewed for Code

 Compliance

DESIGN LOADS

FLOOR/ROOF AREAS	DEAD LOAD	15 PSF
ROOF (TOTAL)	LIVE LOAD	20 PSF
ROOF (SLAB ON GRADE)	DEAD LOAD	25 PSF
WIND DESIGN:		
WIND BASIC WIND VELOCITY =	100 MPH	
IMPORTANCE FACTOR = Iw =	1.00	
EXPOSURE CATEGORY =	DNEN	
BUILDING CATEGORY =	DNEN	
WIND BASE SHEAR Vx =	2.6 KIPS	
WIND BASE SHEAR Vy =	1.4 KIPS	
GROUND SNOW LOAD P _g =	10 PSF	
EXPOSURE FACTOR C _e =	1.1	
THERMAL FACTOR C _t =	1.1	
IMPORTANCE FACTOR I _p =	1.0	
SNOW LOAD S _f =	12.1 PSF	
SEISMIC LOADS:		
IMPORTANCE FACTOR I _e =	1.00	
SEISMIC DESIGN CATEGORY =	B	
RESPONSE MOD = R =	2.5	
S _{DS1} =	0.213	
S _{D1} =	0.125	
DESIGN BASE SHEAR =	Vx = 0.4 KIPS, Vy = 0.4 KIPS	

GENERAL STRUCTURAL NOTES

1. ALL CONSTRUCTION, WORKMANSHIP, AND MATERIALS SHALL CONFORM TO THE LATEST REQUIREMENTS OF THE NORTH CAROLINA BUILDING CODE AND LOCAL REGULATIONS.
2. THE ENGINEER WHOSE SEAL APPEARS ON THESE DRAWINGS IS THE STRUCTURAL ENGINEER OF RECORD FOR THIS PROJECT. NO OTHER PARTY MAY MODIFY OR REUSE THESE CONSTRUCTION DOCUMENTS WITHOUT WRITTEN PERMISSION FROM WOODARD SEASE & ASSOCIATES, P.C. OR STRUCTURAL ENGINEERS WITHOUT DIMENSIONAL ACCURACY OF THE ARCHITECTURAL LAYOUT.
3. THE ENGINEER SHALL HAVE NO LIABILITY TO OTHERS FOR ACTS OR OMISSIONS OF THE CONTRACTOR/BUILDER OR ANY OTHERS PERFORMING WORK ON THIS PROJECT. THE ENGINEER IS NOT RESPONSIBLE FOR CONSTRUCTION REQUIREMENTS, METHODS, OR TECHNIQUES AND/OR SAFETY REQUIREMENTS TO ENSURE THAT THE CONSTRUCTION OF THIS STRUCTURE.
4. THE CONTRACTOR ASSUMES ALL RESPONSIBILITY FROM DEPICTED OR IMPLIED INFORMATION IN CONNECTION WITH THE CONSTRUCTION OF THIS STRUCTURE.
5. ONLY SEALED DRAWINGS ARE APPLICABLE FOR CONSTRUCTION.
6. DEFLECTION: FLOOR: L/360; ATTIC W/ CEILING: L/240; ROOF: L/180 - MORE STRINGENT CRITERIA MAY BE NOTED AT ENGINEER'S DISCRETION OR AS REQUESTED.
7. DO NOT SCALE DRAWINGS. CONTRACTOR SHALL CONTACT ARCHITECT FOR ITEMS NOT DIMENSIONED.
8. THE CONTRACTOR SHALL PROVIDE TEMPORARY BRACING AND SHORING OF ALL STRUCTURAL MEMBERS AS REQUIRED FOR THE STABILITY OF THE STRUCTURE DURING ALL PHASES OF CONSTRUCTION.
9. THE CONTRACTOR SHALL IMMEDIATELY NOTIFY THE ARCHITECT/ENGINEER OF ANY CONDITION WHICH, IN HIS OPINION, MIGHT ENDANGER THE STABILITY OF THE STRUCTURE OR CAUSE DISTRESS WITHIN THE STRUCTURE.
10. SEE ARCHITECTURAL, MECHANICAL, AND ELECTRICAL DRAWINGS FOR MISCELLANEOUS STEEL ITEMS NOT SHOWN.
11. COORDINATE SIZES AND LOCATIONS OF OPENINGS IN FLOORS AND ROOF WITH ARCHITECTURAL, MECHANICAL, AND ELECTRICAL REQUIREMENTS.
12. FOR ACTUAL ELEVATION OF FIRST FLOOR (REF. ELEV. 0'-0"), SEE SITE PLAN.
13. SUBMIT WRITTEN REQUEST TO THE ARCHITECT FOR APPROVAL OF ANY PROPOSED CHANGE TO THE REQUIREMENTS OF THE CONTRACT. SPlicing, CUTTING, NOTCHING OR OTHER ALTERATIONS TO THE STRUCTURAL MEMBERS ARE NOT PERMITTED WITHOUT WRITTEN AUTHORIZATION OF THE ENGINEER. ANY UNAUTHORIZED DEVIATION FROM THE CONTRACT DOCUMENTS, AND CORRECTION THEREOF, IS THE RESPONSIBILITY OF THE CONTRACTOR.
14. THE MOST STRINGENT REQUIREMENTS APPLY IN CASE OF CONFLICT BETWEEN SPECIFICATIONS, STANDARDS, CODES, AND DRAWINGS.

WOOD FRAMING NOTES:

1. ALL WOOD FRAMING SHALL BE KILN DRIED NO. 2 SOUTHERN YELLOW PINE (OR BETTER) IN SIZES AS SHOWN ON THE PLANS, UNLESS OTHERWISE NOTED. TREATED LUMBER FOR ALL EXPOSED.
2. PLYWOOD AND ORIENTED STRAND BOARD (OSB) FOR SHEATHING SHALL COMPLY WITH USDOC PS 1 & PS 2, LATEST EDITION, RESPECTIVELY, AND SHALL HAVE AN APPROPRIATE GRADE TRADE MARK OF AN AMERICAN PLYWOOD ASSOCIATION/ENGINEERED WOOD ASSOCIATION APPROVED AGENCY ON EACH PANEL. PANELS SHALL BE APA RATED SHEATHING, EXPOSURE 1. SHEATHING SHALL BE APPLIED IN FULL SHEETS, OR IN LARGEST PIECES FOR THE AREA BEING COVERED.
3. ALL NAILING FOR WOOD CONSTRUCTION SHALL BE IN ACCORDANCE WITH THE NORTH CAROLINA BUILDING CODE'S FASTENING SCHEDULE UNLESS OTHERWISE NOTED ON THE PLANS.
4. ALL PREBOLTED JOIST HANGERS AND FRAMING ANCHORS SHALL BE FULLY NAILED.
5. ALL LUMBERED VENEER LUMBER (LVL) BEAMS SHALL HAVE THE FOLLOWING MINIMUM PROPERTIES:
 - FLORAL STRESS (F_b): 2600 PSI
 - MODULUS OF ELASTICITY (E): 1,900,000 PSI
 - HORIZONTAL SHEAR (F_v): 285 PSI
 - COMPRESSION PERP TO GRAIN (F_c): 750 PSI

CONCRETE:

1. ALL CONCRETE IS TO BE PROPORTIONED AND PLACED IN ACCORDANCE WITH THE LATEST EDITION OF THE AMERICAN CONCRETE INSTITUTE/ACI 318.
2. CONCRETE SHALL HAVE MINIMUM COMPRESSIVE STRENGTH:
 - SLABS: 3000 PSI
 - FOUNDATIONS: 3000 PSI
 - FOOTINGS: 3000 PSI
3. ALL CONCRETE STEEL REINFORCEMENT TO BE GRADE 60.
4. ALL INTERIOR SLABS TO BE 5" THICK.
5. CONTROL JOINTS ARE TO BE PLACED AS SPECIFIED ON PLANS BOTH DIRECTIONS.
6. ALL INTERIOR SLABS TO BE 7" THICK.
7. WALLS ACTING AS RETAINING WALLS SHALL NOT BE BACKFILLED WITHOUT BRACING UNTIL ALL SUPPORTING SOIL AND SLABS ARE IN PLACE.

FOUNDATION NOTES:

1. ALL FOOTINGS SHALL BE POURED ON COMPACTED SOIL WITH A MINIMUM BEARING CAPACITY OF 2000 PSF.
2. CONTIGUOUS WALL FOOTINGS SHALL BE POURED MONOLITHICALLY WITH COLUMN FOOTINGS.
3. ALL BACKFILL MATERIAL SHALL BE FREE OF DEBRIS. PLACE FILL IN 8" LIFTS WITH COMPACTORS.
4. LIFTS TO A MINIMUM OF 95% OF MAXIMUM DENSITY AT OPTIMUM MOISTURE CONTENT.
5. INSTALL FOUNDATIONS PER GEOTECHNICAL ENGINEER'S REPORT AND FIELD INSPECTIONS.
6. DETERMINATION TYPE AND DESIGN MAY BE FIELD-MODIFIED BASED UPON GEOTECHNICAL ENGINEER'S SITE DETERMINATIONS.
7. WALLS ACTING AS RETAINING WALLS SHALL NOT BE BACKFILLED WITHOUT BRACING UNTIL ALL SUPPORTING SOIL AND SLABS ARE IN PLACE.

FOUNDATION PLAN

SCALE: 3/4" = 1'-0"

SECTION

SCALE: 1/4" = 1'-0"

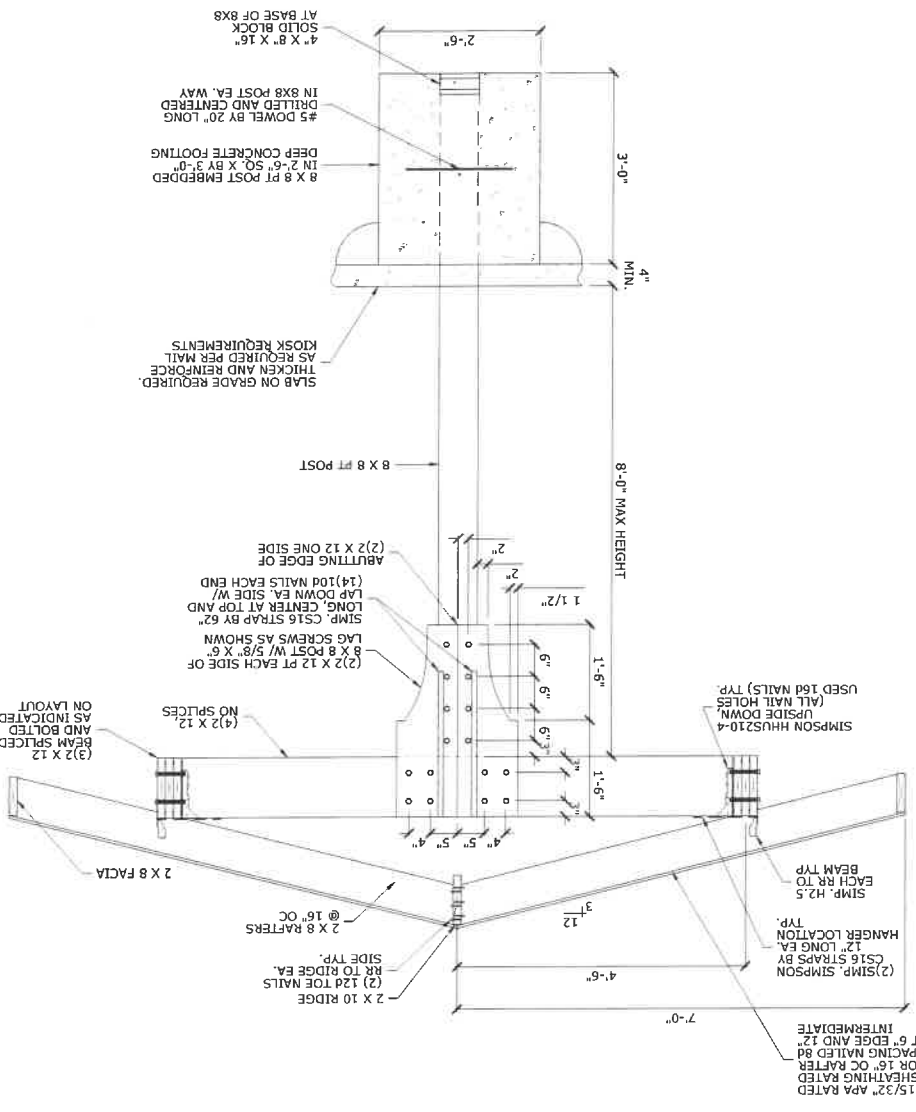

MAIL KIOSK ROOF

WOODGROVE SUBDIVISION, FUQUAY VARINA

HARNETT COUNTY, NORTH CAROLINA

DESIGNER: GREENHAMK CORPORATION PLAN: MAIL KIOSK ROOF

WOODARD SEASE & ASSOCIATES, P.C.

STRUCTURAL ENGINEERS

5535 WESTERN BLVD., SUITE 203 RALEIGH, NC 27608

OFFICE: (919) 307-3899 FAX: (919) 307-3898

SEAL DATE: 09/16/2021

C-3041

WOODARD SEASE & ASSOCIATES, P.C.

STRUCTURAL ENGINEERS

5535 WESTERN BLVD., SUITE 203 RALEIGH, NC 27608

OFFICE: (919) 307-3899 FAX: (919) 307-3898