

PLUMBING NOTES:

- PLUMBING PLANS ARE INTENDED TO PROVIDE INFORMATION FOR INSTALLATION OF A COMPLETE PLUMBING SYSTEM. PROVIDE ALL ESSENTIAL LABOR, MATERIALS & DEVICES REQUIRED TO PRODUCE A QUALITY END PRODUCT.
- CONTRACTOR SHALL REVIEW & BECOME FAMILIAR WITH THE WORK OF ALL TRADES FOR PURPOSES OF COORDINATION AND ROUTING. CONTRACTOR SHALL PROVIDE REQUIRED PLANNING, COORDINATION AND SEQUENCING OF PLUMBING INSTALLATION WITH BUILDING COMPONENTS AND OTHER TRADES.
- COORDINATE CONNECTION OF PLUMBING SYSTEMS WITH SITE UTILITIES AND SERVICES.
- COORDINATE ROOF VENT LOCATIONS WITH OUTSIDE AIR INTAKES OF HVAC UNITS TO MAINTAIN A MINIMUM CLEARANCE OF 10 FEET.
- ALL WORK SHALL COMPLY WITH LOCAL, STATE & ADA CODES. WORKMANSHIP SHALL MEET OR EXCEED INDUSTRY STANDARDS.
- DRAIN, WASTE & VENT (DWV) PIPING SHALL BE ASTM D 1784, SOLID-WALL, SCHEDULE 40 PVC WITH SOCKET TYPE FITTINGS AND SOLVENT-WELDED JOINTS. FOAM CORE PIPING IS NOT ACCEPTABLE.
- ABOVE GRADE WATER PIPING SHALL BE ASTM F 877 CROSS-LINKED POLYETHYLENE (PEX) PLASTIC TUBING.
- WATER SERVICE PIPING SHALL BE ASTM D 1784 PRESSURE-RATED SCHEDULE 40 PVC WITH PVC FITTINGS AND SOLVENT-WELDED JOINTS.
- INDIVIDUAL SUPPLY AND DRAIN CONNECTIONS SIZES ARE NOT INDICATED ON PLANS FOR CLARITY. SIZE EACH TO SUIT RESPECTIVE FIXTURE.
- WATER PIPING INSTALLED IN UNCONDITIONED SPACE SHALL BE INSULATED WITH FIBERGLASS INSULATION WITH A MINIMUM R VALUE OF 6.5.
- DOMESTIC COLD AND HOT WATER PIPING SHALL BE INSULATED WITH FIBERGLASS AND FOIL & PAPER JACKET AS FOLLOWS:
 RUNOUTS 3/4" OR LESS: 1/2" THICK
 PIPING 3/4" TO 2" 1" THICK
 PIPING 2 1/2" & LARGER: 1 1/2" THICK
- WATER PIPING ON OUTSIDE WALLS AND IN CEILING SHALL BE LOCATED BETWEEN BUILDING INSULATION AND CONDITIONED SPACE.
- PROVIDE SHUTOFF VALVES AT EACH MAIN BRANCH LINE. VALVES SHALL BE INSTALLED IN A READILY ACCESSIBLE LOCATION. PROVIDE CEILING ACCESS DOORS WHERE REQUIRED TO ACCESS SERVICABLE VALVES LOCATED ABOVE GYPBOARD CEILINGS.
- PIPING PASSING THROUGH CONCRETE/MASONRY WALLS OR FLOORS SHALL BE PROTECTED AGAINST EXTERNAL CORROSION BY PROTECTIVE SHEATHING OR WRAPPING.
- INSTALL SCHEDULE 40 PIPE SLEEVE TWO SIZES LARGER AT PENETRATIONS THROUGH FOUNDATION WALLS. SEAL SLEEVE TIGHT TO FOUNDATION WALL.
- PROVIDE INSULATION EQUAL TO MCGUIRE PROWRAP ON P-TRAP ASSEMBLIES AND HOT & COLD WATER PIPING FOR LAVATORIES WITH EXPOSED PIPING.
- VERIFY FINAL LOCATIONS FOR ROUGH-INS WITH FIELD MEASUREMENTS AND WITH THE REQUIREMENTS OF THE ACTUAL EQUIPMENT TO BE CONNECTED.
- INSTALL PLUMBING FIXTURES AND EQUIPMENT LEVEL & PLUMB. ROUTE PIPING PARALLEL & PERPENDICULAR TO OTHER BUILDING SYSTEMS AND COMPONENTS.
- INSTALL EQUIPMENT TO FACILITATE SERVICING, MAINTENANCE & REPAIR IN ACCORDANCE WITH MFG'S WRITTEN INSTALLATION INSTRUCTIONS AS WELL AS SPECIFIC INSTRUCTIONS ON PLANS.
- DWV AND WATER DISTRIBUTION PIPING SHALL BE TESTED IN ACCORDANCE WITH NC PLUMBING CODE SECTION 312.

PLUMBING LEGEND		
SYMBOL	ABBR	DESCRIPTION
---	CW	COLD WATER LINE
---	HW	HOT WATER LINE
---	W	SOIL OR WASTE LINE
---	VT	VENT LINE
⊠	AAV	AIR ADMITTANCE VALVE
⊠	VTR	VENT THRU ROOF
⊠	WCO	WALL CLEANOUT
⊠	FCO	FLOOR CLEANOUT
⊠	COG	CLEANOUT ON GRADE
⊠	FD	ROUND FLOOR DRAIN
⊠	FS	FLOOR SINK
⊠	HB	HOSE BIBB/HYDRANT
⊠	FHB	FROSTPROOF HOSE BIBB/HYDRANT
⊠	A	COMPRESSED AIR PIPING
⊠	G	GAS PIPING
⊠	-	CHECK VALVE
⊠	-	SHUTOFF VALVE
⊠	-	GAS COCK
⊠	BFP	BACKFLOW PREVENTER
⊠	-	UNION
⊠	-	CONCENTRIC REDUCER
⊠	-	FLOW DIRECTION ARROW
⊠	-	FIXTURE MARK (SEE SCHEDULE)
⊠	G.C.	GENERAL CONTRACTOR
⊠	P.C.	PLUMBING CONTRACTOR
⊠	M.C.	MECHANICAL CONTRACTOR
⊠	E.C.	ELECTRICAL CONTRACTOR
⊠	AF	ABOVE FINISHED FLOOR
⊠	AFG	ABOVE FINISHED GRADE
⊠	BFG	BELOW FINISHED GRADE

PLUMBING SPECIALTIES SCHEDULE			
MARK	DESCRIPTION	MANF.	REFERENCE MODEL NO.
FCO	FLOOR CLEANOUT	ZURN	ZN-1400
COG	CLEANOUT ON GRADE	ZURN	Z-1449
GI-1	GREASE INTERCEPTOR	WATTS	WD-20
HB	WALL FAUCET	WOODFORD	24 SERIES
FS-1	FLOOR SINK WITH 3/4 GRATE	ZURN	Z-1901-3"-3-25
UB-1	UTILITY BOX - ICE MAKER	OATEY	38681 WITH 3/8" VALVE

- NOTE:**
- CONTRACTOR MAY SUBSTITUTE FIXTURES OF EQUAL QUALITY.

TANKLESS GAS WATER HEATER SCHEDULE										
MARK	GPM	TEMP. RISE	INPUT CAPACITY	EFFICIENCY	CW CONN.	HW CONN.	GAS CONN.	MANF.	MODEL	WEIGHT
WH-1	4.8	80°F	199,999 BTUH	93%	3/4"	3/4"	3/4"	RINNAI	CU199e	50 LBS.

- NOTES:**
- SET OUTLET WATER TEMPERATURE AT 140°F.
 - CONTRACTOR MAY SUBSTITUTE FIXTURES OF EQUAL QUALITY.

PLUMBING FIXTURE SCHEDULE					
FIX NO	DESCRIPTION	CW	HW	WASTE	REFERENCE MODEL NO.
MS-1	MOP SINK 24"x24"x10" DEEP	1/2"	1/2"	2"	FIAT MSB2424 SYMMONS-2490 FAUCET OR EQUAL
SK-1	HAND WASH SINK	1/2"	1/2"	1 1/2"	JUST A-544-912-TA FAUCET; JUST JS-45-TGA OR EQUAL
SK-2	KITCHEN SINK	1/2"	1/2"	1 1/2"	BY OWNER
SK-3	KITCHEN SINK 4 COMPARTMENT	1/2"	1/2"	1 1/2"	BY OWNER

- NOTES:**
- P.C. SHALL COORDINATE ADA WATER CLOSET TRIP LEVER TO BE LOCATED ON WIDE SIDE OF STALL OR TOILET ROOM.
 - FIXTURES MAY BE SUBSTITUTED FOR EQUAL MANUFACTURER.

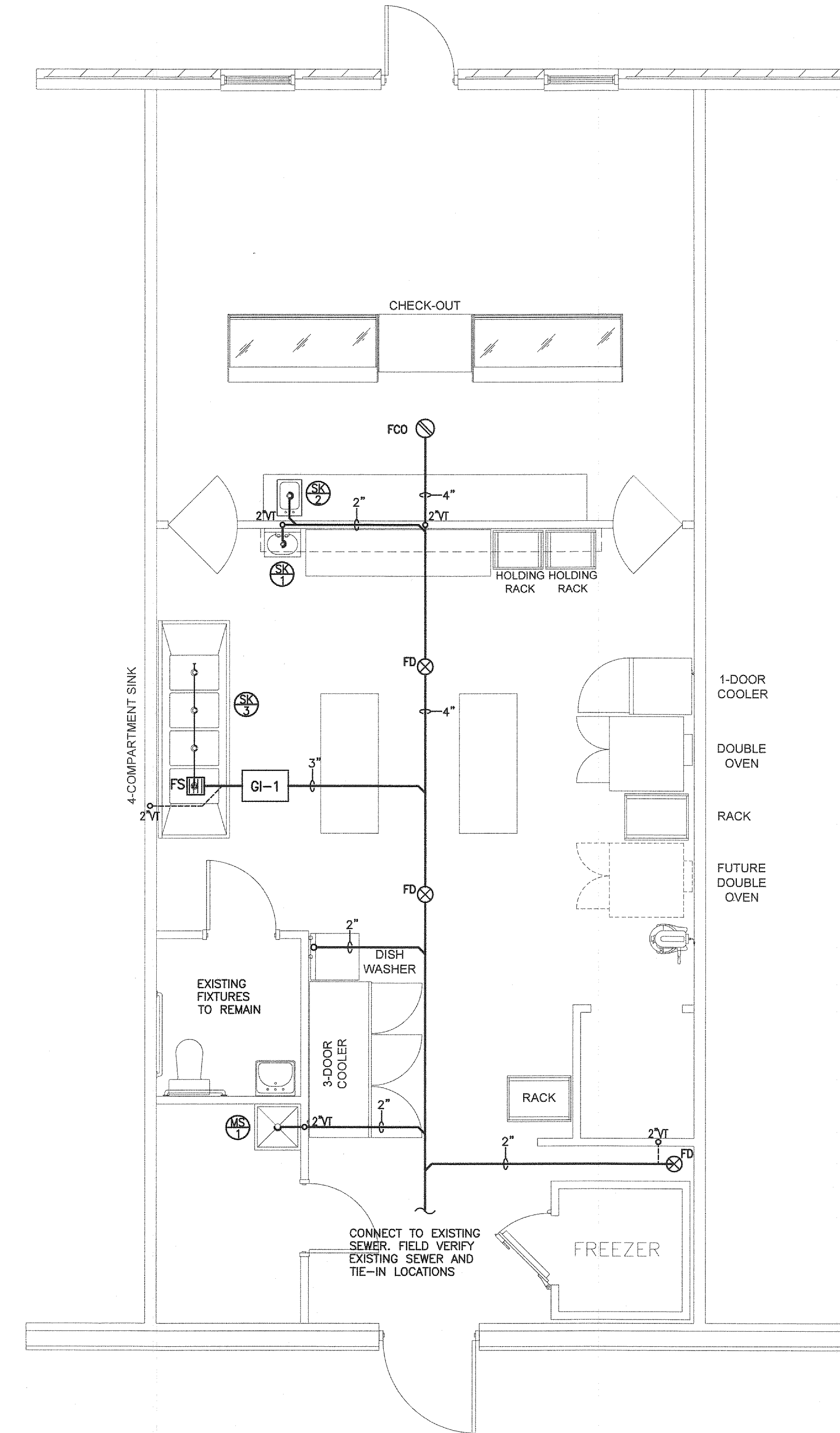

1 PLUMBING PLAN - DRAIN WASTE & VENT PIPING LAYOUT
 SCALE: 1/4" = 1'-0"

SMITH ENGINEERING AND DESIGN, P.A.
 1103 Gacie Place, Suite A
 Goldsboro, N.C. 27534
 Corporation License No. C-2241
 Phone: 919.736.2141 Fax: 919.736.2142

SMITH ENGINEERING AND DESIGN, P.A.
 PROFESSIONAL SEAL
 024916
 5.24.21
 ENGINEER
 J.C. T. SMITH, P.E.

REVISIONS	
REV	DESCRIPTION

The Bake Lab
 67 Marshbanks St.
 Lillington, NC 27546

DATE: 24 May 2021
 DRAWN BY: JS
 SCALE: 1/4" = 1'-0"

P-1