



WEEKLY REPORT

Report Date: 10/14/21

S&ME, Inc.
3201 Spring Forest Road
Raleigh, NC 27616
Phone: 919-872-2660
Fax: 919-876-3958

Client:
SHEETZ, Inc.
1737 White Kennel Road
Burlington, NC 27215

Project:
214164
Sheetz #716 Cameron
Intersection of Sawyer Rd and NC Hwy 24
Cameron, NC 28326

S&ME, Inc. (S&ME) is continuing to provide construction materials testing services at the above referenced project. This letter outlines the results of the services provided and performed by S&ME for the weeks ending October 2 and 9, 2021. This report has been prepared in accordance with generally accepted construction material testing practices for specific application to this project. If changes in the intended use, or design of the construction occur after the date of this report, this report will not be considered valid unless these changes are reviewed, and our recommendations modified or verified in writing. The recommendations contained in this report are based upon applicable standards of our practice in this geographic area at the time this report was prepared. No other warranty, expressed or implied, is made. S&ME, Inc. appreciates the opportunity to be of service to you during this phase of the project. If you should have any questions, or if we may be of further assistance, please feel free to contact us.

Sincerely,
S&ME, Inc.

Table of Contents

Title	Description	Number
DAILY REPORT	Activity Date-2021-09-29 Project-214164	DR-000032
DAILY REPORT	Activity Date-2021-09-30 Project-214164	DR-000033
DAILY REPORT	Activity Date-2021-10-04 Project-214164	DR-000034
DAILY REPORT	Activity Date-2021-10-05 Project-214164	DR-000035

Prepared by:
Lisa STAFFORD
Oct 14, 2021



S&ME, Inc.
3201 Spring Forest Road
Raleigh, NC 27616
Phone: 919-872-2660
Fax: 919-876-3958

Client:
SHEETZ, Inc.
1737 White Kennel Road
Burlington, NC 27215

Project:
214164
Sheetz #716 Cameron
Intersection of Sawyer Rd and NC Hwy 24
Cameron, NC 28326

CONCRETE - Placement - Tests - .

09/29/2021 - NICHOLAS GEMBERLING - Part Time - 7.00 Hours

Observed the placement of approximately ten cubic yards of concrete in the sign footings . The concrete was placed directly from truck chute . The placement required normal weight non-air entrained 4000 psi concrete. The approved concrete mix for this work is S&W Concrete .

The batch tickets were checked to confirm the correct concrete mix was delivered. The slump of each load of concrete was visually estimated prior to placement.

The fresh concrete was sampled from the truck chute and tested for slump, air content, concrete temperature and unit weight. One set of five 4" x 8" test cylinders were cast and stored on site.

The concrete mix, slump, air content, concrete temperature and elapsed time from batching to placement complied with project specifications. This information is presented on the attached Concrete Placement Record and was communicated to foreman with Gates Concrete prior to leaving the site.

[CONCRETE PLACEMENT RECORD](#)

Reviewed/Prepared by:
Brian GLIDEWELL
Oct 14, 2021



S&ME, Inc.
 3201 Spring Forest Road
 Raleigh, NC 27616
 Phone: 919-872-2660 | Fax: 919-876-3958

CONCRETE PLACEMENT RECORD

Report #: CPS-000013
Report Date: 10/14/2021

Client:
 SHEETZ, Inc.
 1737 White Kennel Road
 Burlington, NC 27215

Project:
 214164
 Sheetz #716 Cameron
 Intersection of Sawyer Rd and NC Hwy 24
 Cameron, NC 28326

Placement Date: 09/29/21		Placement Location: FOUNDATION			Placement Method: Chute				Technician: NICHOLAS GEMBERLING					
Weather: Sunny		Location Details: Sign post footings			Mix Design: G40CBNA (4000 psi)				Specified Strength (psi): 4000					
Contractor: Gates Concrete		Supplier: 05-S & W Concrete												
Sample	Set	Truck # Ticket #	Load Volume (yd ³)	Times	Placement Time (min)	Consistency	Air Content (%)	Unit Weight (lb/ft ³)	Concrete Temp (F)	Air Temp (F)	On-Site Admixtures	Specimens Cast	Specimen Size	Sample Type
265457	16	414 2446788	10.00	Batched: 13:41 EDT Arrived: 14:10 EDT Empty: 14:50 EDT	69	Slump: 5 in. Spec: 3 - 5	Result: 1.4 Spec: 0 - 3	145.8	87	82	None	5	4" X 8"	CC

The presence of S&ME at the project site shall not be construed as an acceptance or approval of activities at the site. S&ME is at the site to perform specific services requested and has certain responsibilities which are limited to those specifically authorized in our agreement with our client. The results of tests or observations performed are only applicable to the time and location of the tests or observations. If our work is scheduled by others, we are not responsible for the testing frequency. In no event shall S&ME be responsible for the safety or means and methods of other parties at the project site.



S&ME, Inc.
3201 Spring Forest Road
Raleigh, NC 27616
Phone: 919-872-2660
Fax: 919-876-3958

Client:
SHEETZ, Inc.
1737 White Kennel Road
Burlington, NC 27215

Project:
214164
Sheetz #716 Cameron
Intersection of Sawyer Rd and NC Hwy 24
Cameron, NC 28326

CONCRETE - Post Placement - Sample Pickup - Generally Conforms with Required

09/30/2021 - Michael A. WILLIAMS - Continuous - 2.50 Hours - 13:00 to 15:30

Picked up concrete test cylinders cast on 9/29 and transported them to S&ME laboratory for curing and compressive strength testing. The cylinders were picked up @ 14:00.

Reviewed/Prepared by:
Brian GLIDEWELL
Oct 14, 2021



S&ME, Inc.
3201 Spring Forest Road
Raleigh, NC 27616
Phone: 919-872-2660
Fax: 919-876-3958

Client:
SHEETZ, Inc.
1737 White Kennel Road
Burlington, NC 27215

Project:
214164
Sheetz #716 Cameron
Intersection of Sawyer Rd and NC Hwy 24
Cameron, NC 28326

CONCRETE - Pre-Placement - Observations - Generally Conforms with Required

10/04/2021 - HAZEM ISMAIL - Full Time - 0.50 Hours

Observed the placement of the concrete reinforcing steel in Light poles. The reinforcing steel placement was evaluated with respect to the number of bars, bar sizes, spacing, lap splice lengths, cleanliness, and cover.

In summary, placement of the reinforcing steel was found to be in Accordance with the structural drawings and design details Sheet D1 Drawing w-3891.

The project superintendent was notified of these findings prior to departing from the site.



S&ME, Inc.
3201 Spring Forest Road
Raleigh, NC 27616
Phone: 919-872-2660
Fax: 919-876-3958

Client:
SHEETZ, Inc.
1737 White Kennel Road
Burlington, NC 27215

Project:
214164
Sheetz #716 Cameron
Intersection of Sawyer Rd and NC Hwy 24
Cameron, NC 28326

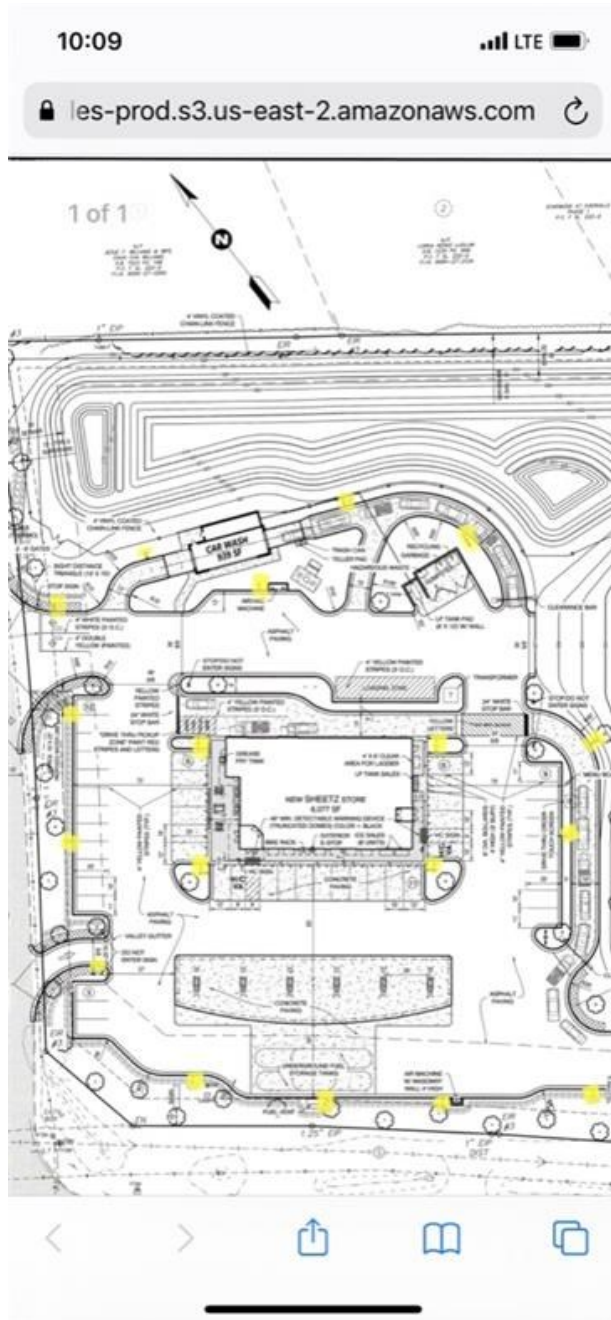

Light pole locations

**CONCRETE - Placement - Tests and Observations - Generally Conforms with Required
10/04/2021 - HAZEM ISMAIL - Full Time - 6.00 Hours**

Observed the placement of approximately 10 cubic yards of concrete in the Light posts. The



S&ME, Inc.
3201 Spring Forest Road
Raleigh, NC 27616
Phone: 919-872-2660
Fax: 919-876-3958

Client:
SHEETZ, Inc.
1737 White Kennel Road
Burlington, NC 27215

Project:
214164
Sheetz #716 Cameron
Intersection of Sawyer Rd and NC Hwy 24
Cameron, NC 28326

concrete was placed directly from the truck chute. The placement required normal weight , Air entrained 4000 psi concrete.

The batch tickets were checked to confirm the correct concrete mix was delivered. The slump of each load of concrete was visually estimated prior to placement.

The fresh concrete was sampled from the truck chute and tested for slump, air content, concrete temperature, and unit weight. One set of five 4" x 8" test cylinders were cast and stored on site.

The concrete mix, slump, air content, concrete temperature and elapsed time from batching to placement complied with project specifications. This information is presented on the attached Concrete Placement Record and was communicated to Representative with Gates concrete prior to leaving the site.



S&ME, Inc.
3201 Spring Forest Road
Raleigh, NC 27616
Phone: 919-872-2660
Fax: 919-876-3958

Client:
SHEETZ, Inc.
1737 White Kennel Road
Burlington, NC 27215

Project:
214164
Sheetz #716 Cameron
Intersection of Sawyer Rd and NC Hwy 24
Cameron, NC 28326

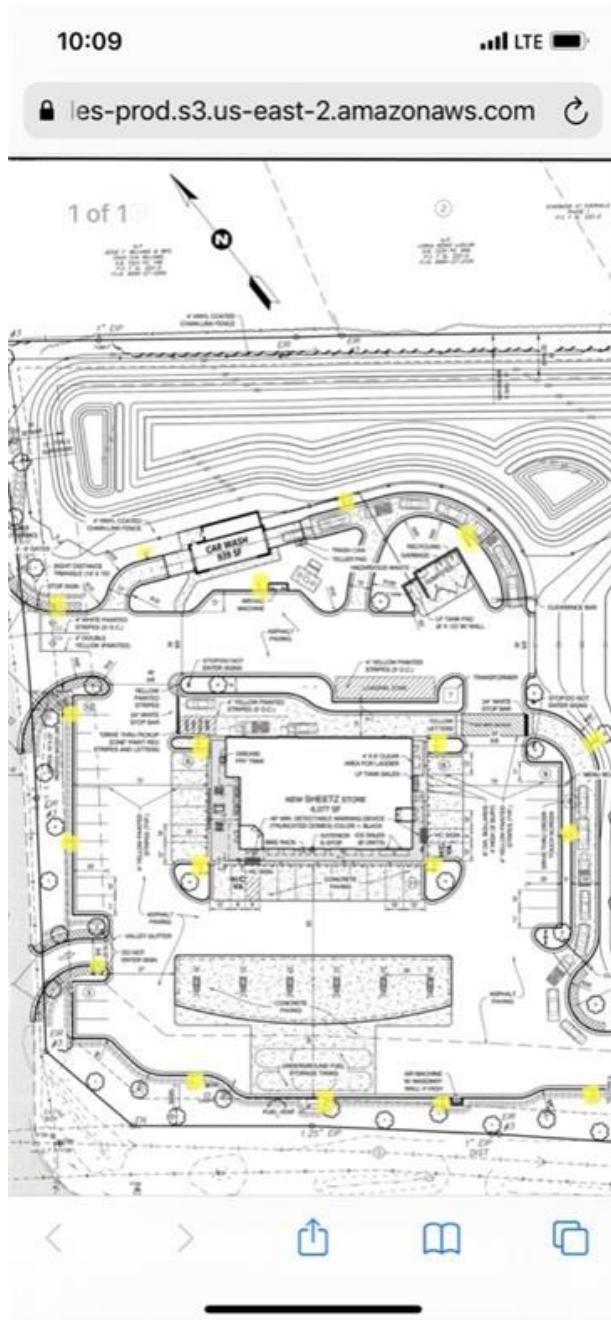

CONCRETE PLACEMENT RECORD

The presence of S&ME at the project site shall not be construed as an acceptance or approval of activities at the site. S&ME is at the site to perform specific services and has certain responsibilities which are limited to those specifically authorized in our agreement with our client. The results of tests or observations performed are only applicable to the time and location of the tests or observations. Testing frequency is dependent on our being informed of work in progress at the site and staffing level. In no event shall S&ME be responsible for the safety or means and methods of other parties at the project site.



DAILY REPORT

Report #: DR-000034
Report Date: 10/14/2021



S&ME, Inc.
3201 Spring Forest Road
Raleigh, NC 27616
Phone: 919-872-2660
Fax: 919-876-3958

Client:

SHEETZ, Inc.
1737 White Kennel Road
Burlington, NC 27215

Project:

214164
Sheetz #716 Cameron
Intersection of Sawyer Rd and NC Hwy 24
Cameron, NC 28326

Reviewed/Prepared by:
Brian GLIDEWELL
Oct 14, 2021

The presence of S&ME at the project site shall not be construed as an acceptance or approval of activities at the site. S&ME is at the site to perform specific services and has certain responsibilities which are limited to those specifically authorized in our agreement with our client. The results of tests or observations performed are only applicable to the time and location of the tests or observations. Testing frequency is dependent on our being informed of work in progress at the site and staffing level. In no event shall S&ME be responsible for the safety or means and methods of other parties at the project site.



S&ME, Inc.
 3201 Spring Forest Road
 Raleigh, NC 27616
 Phone: 919-872-2660 | Fax: 919-876-3958

CONCRETE PLACEMENT RECORD

Report #: CPS-000014
Report Date: 10/14/2021

Client:
 SHEETZ, Inc.
 1737 White Kennel Road
 Burlington, NC 27215

Project:
 214164
 Sheetz #716 Cameron
 Intersection of Sawyer Rd and NC Hwy 24
 Cameron, NC 28326

Placement Date: 10/04/21		Placement Location: PAVEMENT				Placement Method: Chute				Technician: HAZEM ISMAIL				
Weather: Sunny		Location Details: Light poles				Mix Design: G40CB (4000 psi)				Specified Strength (psi): 4000				
Contractor: Gates		Supplier: 05-S & W Concrete												
Sample	Set	Truck # Ticket #	Load Volume (yd ³)	Times	Placement Time (min)	Consistency	Air Content (%)	Unit Weight (lb/ft ³)	Concrete Temp (F)	Air Temp (F)	On-Site Admixtures	Specimens Cast	Specimen Size	Sample Type
266150	17	2016 2446792	10.00	Batched: 12:37 EDT Arrived: 13:02 EDT Empty: 13:42 EDT	65	Slump: 6 in. Spec: 5 - 7	Result: 4.5 Spec: 4 - 7	143.9	80	80	None	5	4" X 8"	CC

The presence of S&ME at the project site shall not be construed as an acceptance or approval of activities at the site. S&ME is at the site to perform specific services requested and has certain responsibilities which are limited to those specifically authorized in our agreement with our client. The results of tests or observations performed are only applicable to the time and location of the tests or observations. If our work is scheduled by others, we are not responsible for the testing frequency. In no event shall S&ME be responsible for the safety or means and methods of other parties at the project site.



S&ME, Inc.
3201 Spring Forest Road
Raleigh, NC 27616
Phone: 919-872-2660
Fax: 919-876-3958

Client:
SHEETZ, Inc.
1737 White Kennel Road
Burlington, NC 27215

Project:
214164
Sheetz #716 Cameron
Intersection of Sawyer Rd and NC Hwy 24
Cameron, NC 28326

CONCRETE - Post Placement - Sample Pickup - Generally Conforms with Required

10/05/2021 - HAZEM ISMAIL - Full Time - 2.00 Hours

Picked up concrete test cylinders cast on 10/4 and transported them to S&ME laboratory for curing and compressive strength testing.

Reviewed/Prepared by:
Brian GLIDEWELL
Oct 14, 2021