

REAR DOOR TO KITCHEN AREA SHALL REMAIN LOCKED AT ALL TIMES TO PROHIBIT ACCESS EXCEPT AS DIRECTED BY HCS STAFF

ALL PASS THROUGH EQUIPMENT RELOCATED TO WITHIN THE CONFINES OF THE KITCHEN AREA

TEMPORARY BARRIERS TO PROHIBIT ACCESS TO THE KITCHEN AREA

ALL SERVING LINE EQUIPMENT RELOCATED TO WITHIN THE CONFINES OF THE KITCHEN AREA

OVERHEAD ACCESS DOOR TO SCULLERY TO REMAIN CLOSED AND LOCKED AT ALL TIMES

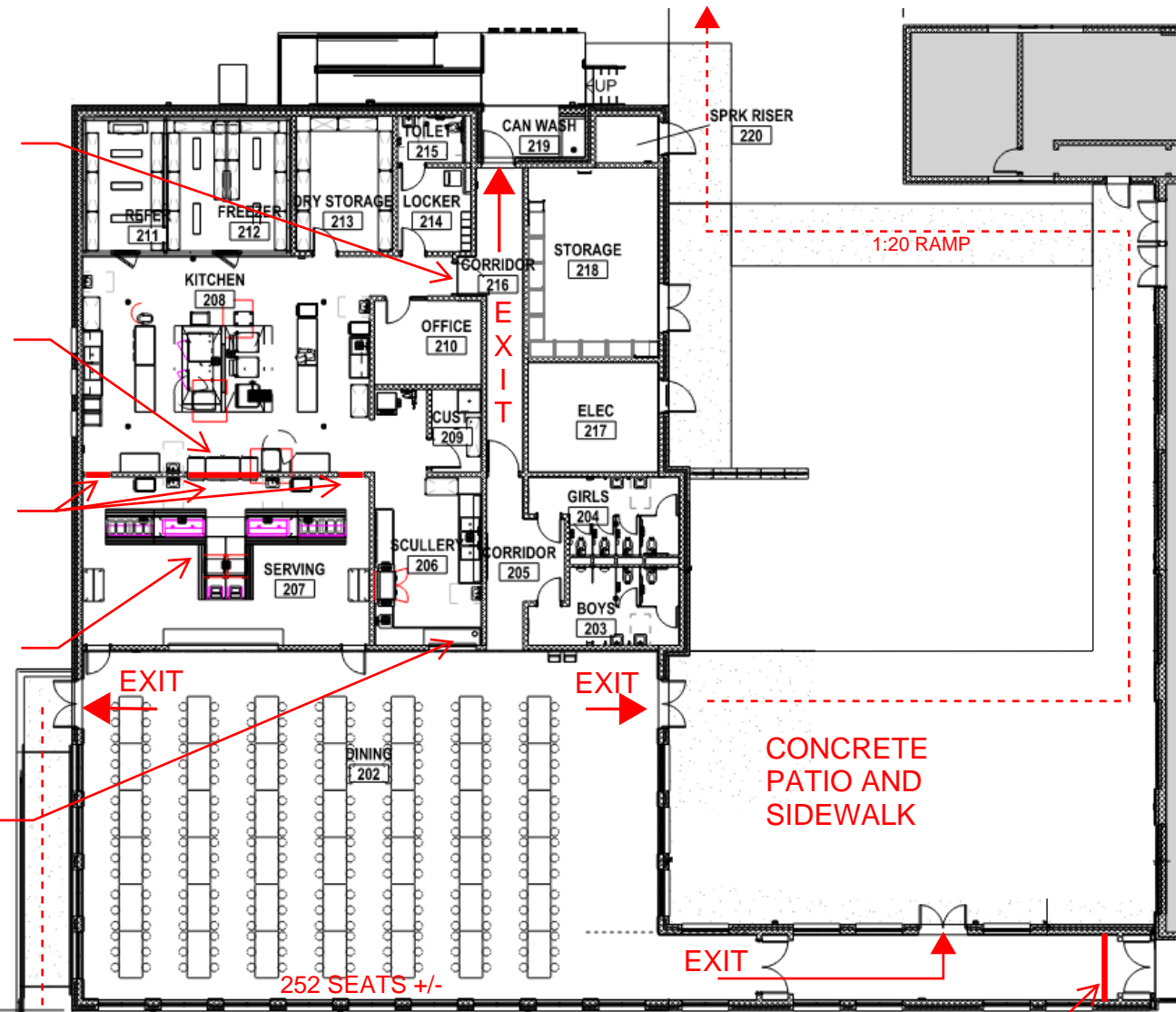

JOHNSONVILLE ES P1 OCCUPANCY DIAGRAM:  
OCCUPANCY: ASSEMBLY SPACE  
POSTED MAXIMUM OCCUPANCY FOR THE  
DINING AREA: 471 OCCUPANTS

CONNECTION CORRIDOR  
TEMPORARY BARRIER  
CURRENTLY IN PLACE TO  
PROHIBIT ACCESS TO  
GYMNASIUM LOBBY AREA

**sfi+a**

ARCHITECTS

Capital Bank Plaza

333 Fayetteville Street, Suite 225

Raleigh NC 27601

8.22.2023