

Harnett

NORTH CAROLINA DEPARTMENT OF TRANSPORTATION
DIVISION OF HIGHWAYS
DRIVEWAY PERMIT APPROVED

BY Earl Lee

DATE 11-26-19

ANY PARCELS OR EXCLUDED AREAS
ARE TO BE SERVED INTERNALLY WITH
NO ACCESS ONTO DEPARTMENTAL
RIGHT OF WAY

ONLY NORTH CAROLINA DEPARTMENT
OF TRANSPORTATION APPROVED
STRUCTURES ARE TO BE
CONSTRUCTED ON PUBLIC
RIGHT OF WAY.



LEGEND



GIS/E-911 Addressing
November 26, 2019

- Recycle Center
- Landfills
- Surrounding County Boundaries
- Federal Property
- City Limits
- Harnett County Boundary
- Address Numbers
- Airport
- Major Roads
 - US
 - Interstate
 - NC
- Railroad
- Parcels
- Cape Fear River

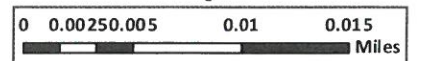

1 inch = 47 feet

date of conditional use permit 1/2" GATE'S
BOA 1908-003
sept. 9, 2019

2767 JOE/JOHNSON Rd.
Lillington, N.C. 27546

NORTH CAROLINA DEPARTMENT
OF TRANSPORTATION
DIVISION OF HIGHWAYS
DRIVEWAY PERMIT APPROVED

BY [Signature]

DATE 11-26-19

ANY PARCELS OR EXCLUDED AREAS
ARE TO BE SERVED INTERNALLY WITH
NO ACCESS ONTO DEPARTMENTAL
RIGHT OF WAY

ONLY NORTH CAROLINA DEPARTMENT
OF TRANSPORTATION APPROVED
STRUCTURES ARE TO BE
CONSTRUCTED ON PUBLIC
RIGHT OF WAY.

Hours-OPERATION -
6:30 - 5:30 Mon-Fri
No# of STUDENTS
15
of Employee's 3

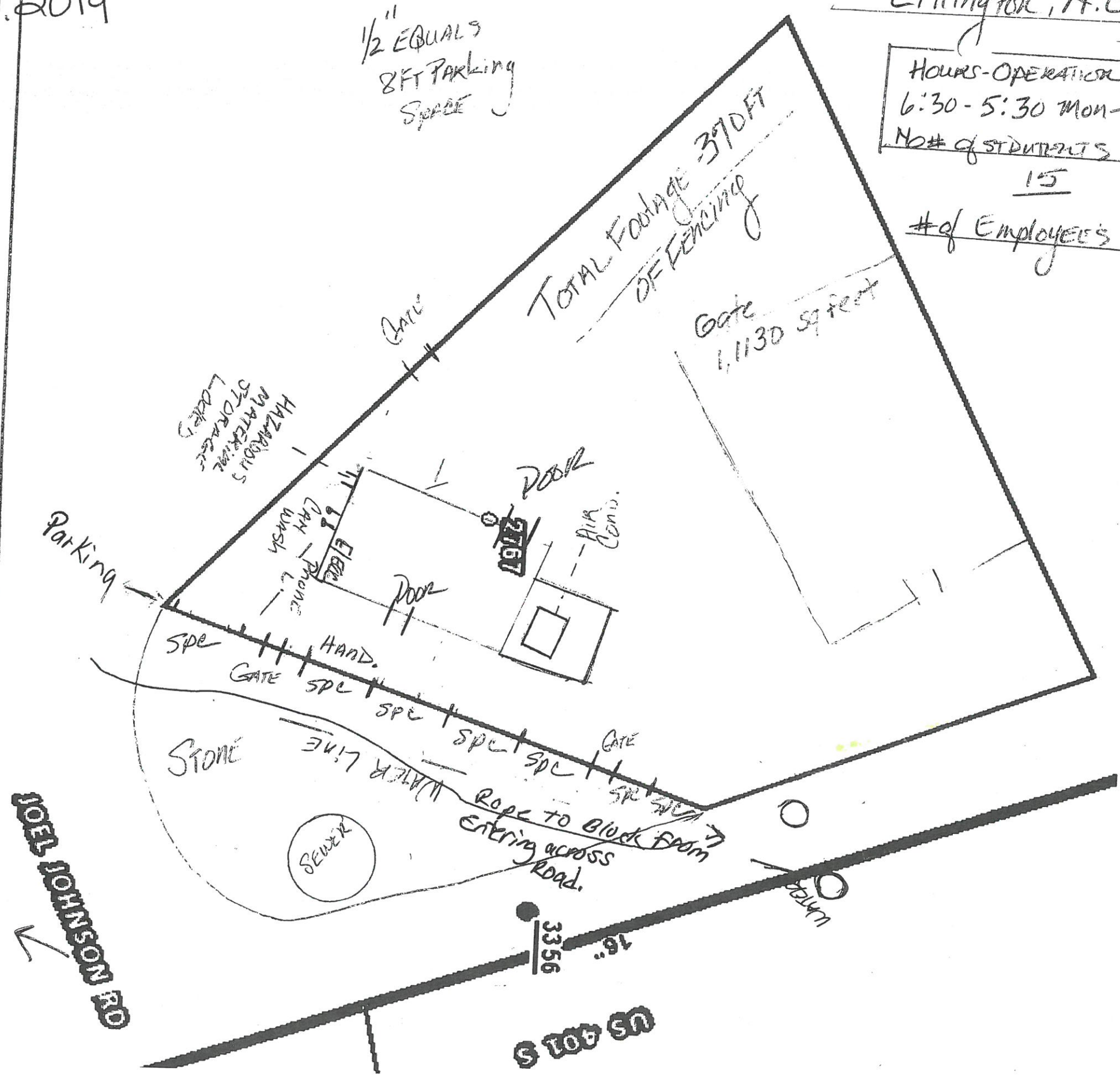

1/2" EQUALS
8 FT PARKING
SPACE

TOTAL FOOTAGE 390 FT
OF FENCING

Gate
1,130 sq feet

HAZARDOUS
MATERIALS
STORAGE
(LADIES)

ELECTRICAL

DAY WASH

PHONE

AIR COND.

STONE

SEWER

WATER LINE

ROAD TO BLOCK FROM
ENTERING across
ROAD.

US 401 S

3356

16"

JOE/JOHNSON RD