

Donna's Country Kitchen - Design Plan

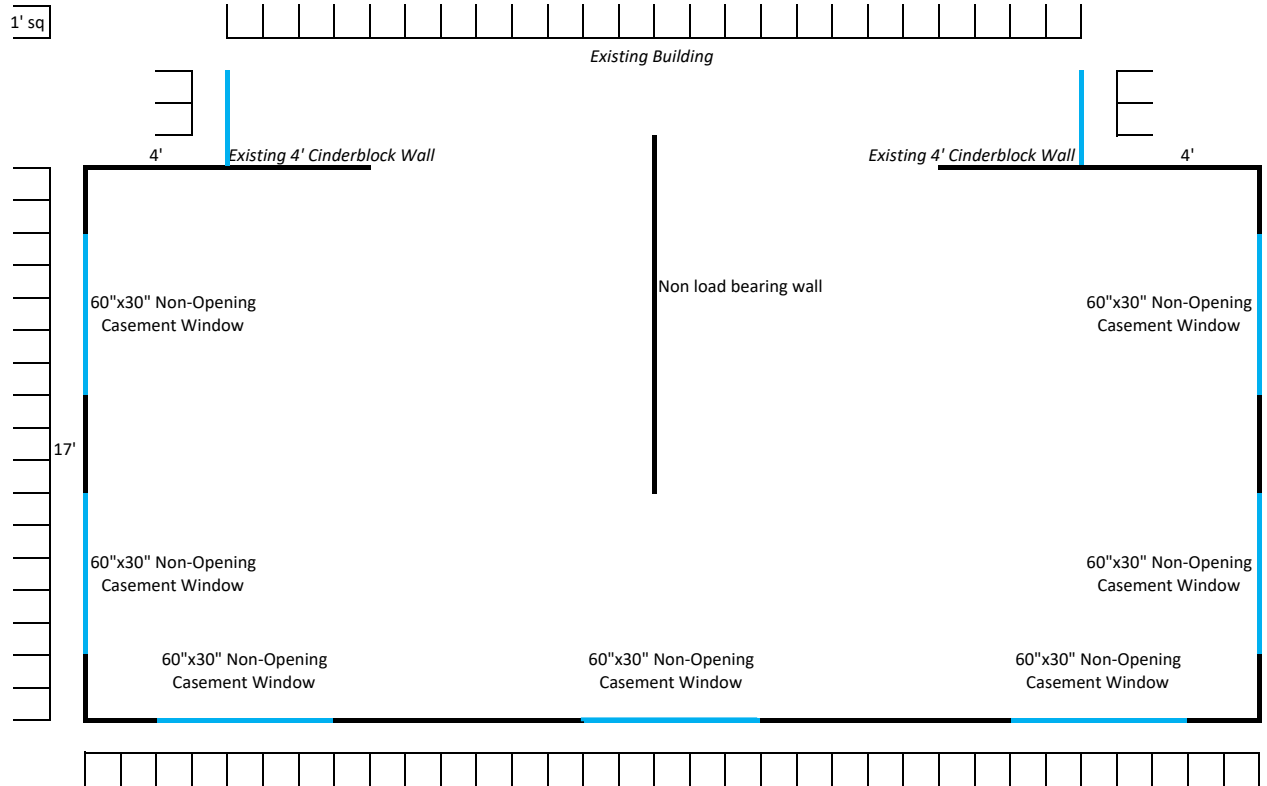

- >> Ceiling height on addition 9'
- >> 2x4 wall construction at 16" on center
- >> 30" x 60" Non-opening Casement Windows
- >> Double 2x8 Header over windows
- >> 1/2 Plywood backing with hardie plank panel exterior
- >> Truss details provided in separate note
- >> Concrete and rebar reinforced footing
- >> Footing depth at 24" below soil line
- >> Footing width a minimum of 12"
- >> Slope adjacent to footing at 5* minimum
- >> R15 exterior wall insulation
- >> R30+ attic insulation