

RE: Fairway Pointe LLC – Building 17 Unit 203

Jan 26, 2021

To whom it may concern:

Below is the standard detail for stubbing a floor truss up to 12”.

AUGUST 1, 2016	STANDARD REPAIR DETAIL FOR STUBBING A FLOOR TRUSS	MII-REP07
----------------	---	-----------

MiTek USA, Inc. Page 1 of 1



1. THIS IS A SPECIFIC REPAIR DETAIL TO BE USED ONLY FOR ITS ORIGINAL INTENTION. THIS REPAIR DOES NOT IMPLY THAT THE REMAINING PORTION OF THE TRUSS IS UNDAMAGED. THE ENTIRE TRUSS SHALL BE INSPECTED TO VERIFY THAT NO FURTHER REPAIRS ARE REQUIRED. WHEN THE REQUIRED REPAIRS ARE PROPERLY APPLIED, THE TRUSS WILL BE CAPABLE OF SUPPORTING THE LOADS INDICATED.
2. ALL MEMBERS MUST BE RETURNED TO THEIR ORIGINAL POSITIONS BEFORE APPLYING REPAIR AND HELD IN PLACE DURING APPLICATION OF REPAIR.
3. THE END DISTANCE, EDGE DISTANCE, AND SPACING OF NAILS SHALL BE SUCH AS TO AVOID SPLITTING OF THE WOOD.
4. LUMBER MUST BE CUT CLEANLY AND ACCURATELY AND THE REMAINING WOOD MUST BE UNDAMAGED.
5. THIS REPAIR IS TO BE USED FOR SINGLE PLY TRUSSES IN THE 4X<sub>1</sub> ORIENTATION ONLY.
6. CONNECTOR PLATES MUST BE FULLY IMBEDDED AND UNDISTURBED.

DUCT OPENINGS MUST BE LOCATED WITHIN 12" OF THE CENTER OF THE ORIGINAL SPAN

REFER TO INDIVIDUAL TRUSS DESIGN FOR PLATE SIZES AND LUMBER GRADES

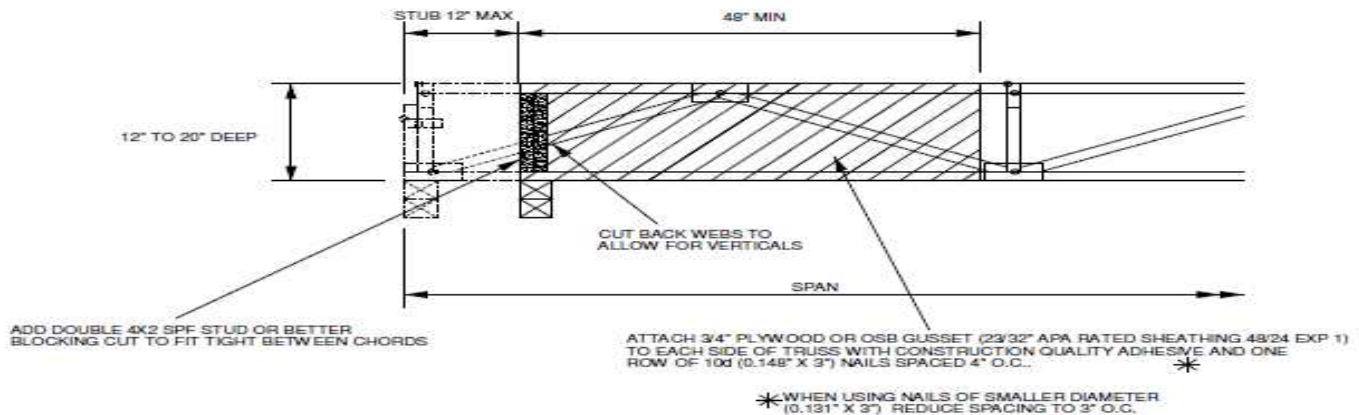

DEPTH	MAX. SPAN		
	24" O.C.	19.2" O.C.	16" O.C.
12"	16'-6"	20'-0"	20'-0"
14"	19'-3"	23'-4"	23'-4"
16"	22'-0"	26'-8"	26'-8"
18"	24'-10"	30'-0"	30'-0"
20"	27'-7"	30'-4"	30'-4"

LOADING  
TOLL - 40 PSF  
TCDL - 10 PSF  
BOLL - 0 PSF  
BCDL - 5 PSF



December 8, 2017

Kelly Hudson  
Components Specialist



A DIVISION OF CARTER LUMBER  
298 Harvey Faulk Rd. Sanford, NC 27332  
Office: 919-775-1450  
Cell: 704-467-1857  
[kelly.hudson@KempsvilleBuilding.com](mailto:kelly.hudson@KempsvilleBuilding.com)