

Harnett County Department of Public Health Improvement Permit

A building permit cannot be issued with only an Improvement Permit

ISSUED TO: Caleb Smith PROPERTY LOCATION: 2280 Cane Mill Road (SR 1700)
 SUBDIVISION _____ LOT # _____
 NEW REPAIR EXPANSION Site Improvements required prior to Construction Authorization Issuance: _____
 Type of Structure: Barn (60'x30') w/ Bath
 Proposed Wastewater System Type: 25% Reduction System
 Projected Daily Flow: 240 GPD
 Number of bedrooms: NA Number of Occupants: NA max
 Basement Yes No
 Pump Required: Yes No May be required based on final location and elevations of facilities
 Type of Water Supply: Community Public Well Distance from well _____ feet Permit valid for: Five years
 Permit conditions: Sized for 240gpd to meet any future structure usage No expiration

Authorized State Agent: [Signature] Date: 04/17/2019 SEE ATTACHED SITE SKETCH
 The issuance of this permit by the Health Department in no way guarantees the issuance of other permits. The permit holder is responsible for checking with appropriate governing bodies in meeting their requirements. This site is subject to revocation if the site plan, plat, or the intended use changes. The Improvement Permit shall not be affected by a change in ownership of the site. This permit is subject to compliance with the provisions of the Laws and Rules for Sewage Treatment and Disposal and to conditions of this permit.

Construction Authorization (Required for Building Permit)

The construction and installation requirements of Rules .1950, .1952, .1954, .1955, .1956, .1957, .1958, and .1959 are incorporated by references into this permit and shall be met. Systems shall be installed in accordance with the attached system layout.

ISSUED TO: Caleb Smith PROPERTY LOCATION: 2280 Cane Mill Road (SR 1700)
 SUBDIVISION _____ LOT # _____
 Facility Type: Barn (60'x30') w/ Bath New Expansion Repair
 Basement? Yes No Basement Fixtures? Yes No
 Type of Wastewater System** 25% Reduction System (Initial) Wastewater Flow: 240 GPD
 (See note below, if applicable 25% Reduction System (Repair))

Installation Requirements/Conditions	Number of trenches <u>2</u>	
Septic Tank Size <u>1000</u> gallons	Exact length of each trench <u>90</u> feet	Trench Spacing: <u>9</u> Feet on Center
Pump Tank Size _____ gallons	Trenches shall be installed on contour at a	Soil Cover: <u>6</u> inches
	Maximum Trench Depth of: <u>18</u> inches	(Maximum soil cover shall not exceed
	(Trench bottoms shall be level to +/-1/4"	36" above the trench bottom)
	in all directions)	
Pump Requirements: _____ ft. TDH vs. _____ GPM		Aggregate Depth: <u>NA</u> inches below pipe
		<u>NA</u> inches above pipe
Conditions: <u>Sized for 240gpd to meet any future structure usage</u>		<u>NA</u> inches total

**WATER LINES (INCLUDING IRRIGATION) MUST BE 10FT. FROM ANY PART OF SEPTIC SYSTEM OR REPAIR AREA.
 NO UTILITIES ALLOWED IN INITIAL OR REPAIR DRAIN FIELD AREA.**

**If applicable: I understand the system type specified is different from the type specified on the application. I accept the specifications of this permit.
 Owner/Legal Representative Signature: _____ Date: _____

This Construction Authorization is subject to revocation if the site plan, plat, or the intended use changes. The Construction Authorization shall not be transferred when there is a change in ownership of the site. This Construction Authorization is subject to compliance with the provisions of the Laws and Rules for Sewage Treatment and Disposal and to the conditions of this permit. SEE ATTACHED SITE SKETCH

Authorized State Agent: [Signature] Date: 04/17/2019
ANDREW CURRIE Construction Authorization Expiration Date: 04/17/2024

HTE# BLOM1904-0001

Permit # NA

Harnett County Department of Public Health Site Sketch

ISSUED TO: Caleb Smith PROPERTY LOCATOR: 2280 Cane Mill Rd. (SR 1700)
SUBDIVISION _____ LOT # _____

Authorized State Agent: Andrew Curran Date: 04/17/2019

TO CANE MILL
RD (SR 1700)

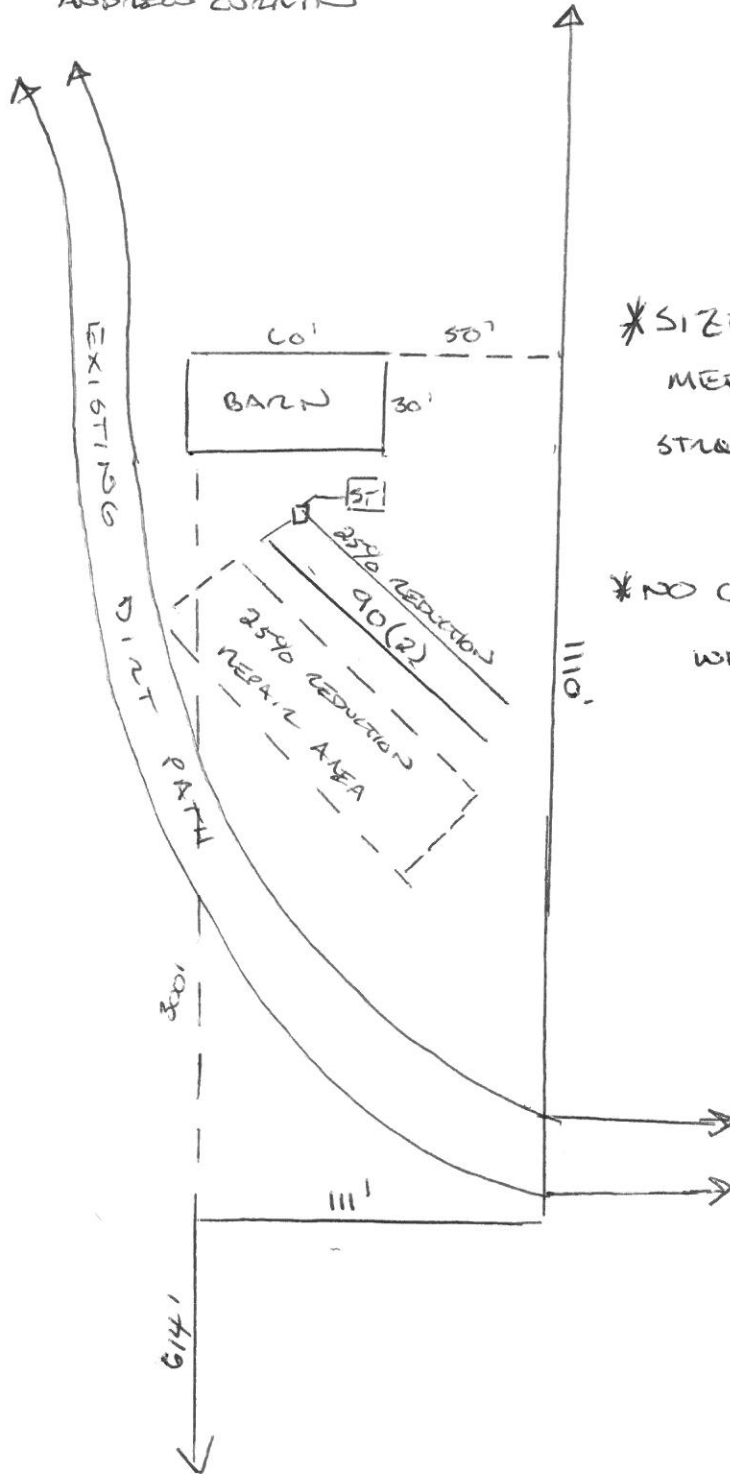

* SIZED 240GPD TO
MEET ANY FUTURE
STRUCTURE USAGE

* NO COUNTY WATER /
WELL APPLIED