

**SOIL/SITE EVALUATION
 for ON-SITE WASTEWATER SYSTEM**

Owner:
 Address:

Applicant:

Date Evaluated:

Proposed Facility: Design Flow (.1949):

Property Size:

Location of Site:

Property Recorded:

Water Supply: Public Individual Well Spring Other
 Evaluation Method: Auger Boring Pit Cut
 Type of Wastewater: Sewage Industrial Process Mixed

| P R O F I L E # | .1940 Landscape Position/ Slope% | Horizon Depth (IN.) | SOIL MORPHOLOGY .1941 | | OTHER PROFILE FACTORS | | | | Profile Class & LTAR |
|--------------------------------------|---|---------------------------|--------------------------------|------------------------------------|------------------------------------|------------------------------|-------------------------|-------------------------|----------------------------|
| | | | .1941 Structure/ Texture | .1941 Consistence Mineralogy | .1942 Soil Wetness/ Color | .1943 Soil Depth (IN.) | .1956 Sapro Class | .1944 Restr Horiz | |
| 45 510 | | 0-30 | G/LS | VF NSMP | | | | | S-8 |
| | | 30-48 | G/SL | VF NSMP | | | | | |
| | | 0-29 | G/LS | VF NSMP | | | | | PS-7 |
| | | 29-39 | SBK/C | F: SSSP | 2.5Y 8/129" | | | | |
| | | 0-34 | G/SL | VF NSMP | | | | | PS-45 |
| | | 34-40 | SBK/SC | F: SP | 10YR 8/240 | | | | |
| | | 0-27 | G/SL | VF NSMP | | | | | PS-45 |
| | | 27-34 | SBK/SC | F: SP | 10YR 8/234 | | | | |
| | | 34+ | | | | | | | |
| | | | | | | | | | |
| | | | | | | | | | |
| | | | | | | | | | |

| Description | Initial System | Repair System |
|-------------------------|----------------|---------------|
| Available Space (.1945) | ✓ | ✓ |
| System Type(s) | 2570 | Repair cover |
| Site LTAR | .3 | .3 |

Other Factors (.1946): _____
 Site Classification (.1948): PS
 Evaluated By: BM
 Others Present: ST

COMMENTS: _____

| <u>LANDSCAPE POSITIONS</u> | <u>GROUP</u> | <u>TEXTURES</u> | <u>.1955 LTAR</u> | <u>CONSISTENCE MOIST</u> | <u>WET</u> |
|----------------------------|--------------|----------------------|-------------------|--------------------------|--------------------|
| R-RIDGE | I | S-SAND | 1.2 - 0.8 | VFR-VERY FRIABLE | NS-NON-STICKY |
| S-SHOULDER SLOPE | | LS-LOAMY SAND | | | |
| L-LINEAR SLOPE | II | SL-SANDY LOAM | 0.8 - 0.6 | FR-FRIABLE | SS-SLIGHTLY STICKY |
| FS-FOOT SLOPE | | L-LOAM | | | |
| N-NOSE SLOPE | III | SI-SILT- | 0.6 - 0.3 | FI-FIRM | S-STICKY |
| H-HEAD SLOPE | | SIL-SILT LOAM | | | |
| CC-CONCLAVE SLOPE | | CL-CLAY LOAM | | | |
| CV-CONVEX SLOPE | | SCL-SANDY CLAY LOAM | | | |
| T-TERRACE | IV | SIC-SILTY CLAY | 0.4 - 0.1 | VFI-VERY FIRM | VS-VERY STICKY |
| FP-FLOOD PLAN | | C-CLAY | | | |
| | | SC-SANDY CLAY | | | |
| | | SICL-SILTY CLAY LOAM | | EFI-EXTREMELY FIRM | NP-NON-PLASTIC |
| | | | | | SP-SLIGHTLY STICKY |
| | | | | | P-PLASTIC |
| | | | | | VP-VERY PLASTIC |

STRUCTURE
 SG-SINGLE GRAIN
 M-MASSIVE
 CR-CRUMB
 GR-GRANULAR
 SBK-SUBANGULAR BLOCKY
 ABK-ANGULAR BLOCKY
 PL-PLATY
 PR-PRISMATIC

MINERALOGY
 SLIGHTLY EXPANSIVE
 EXPANSIVE

Show profile locations and other site features (dimensions, reference or benchmark, and North).

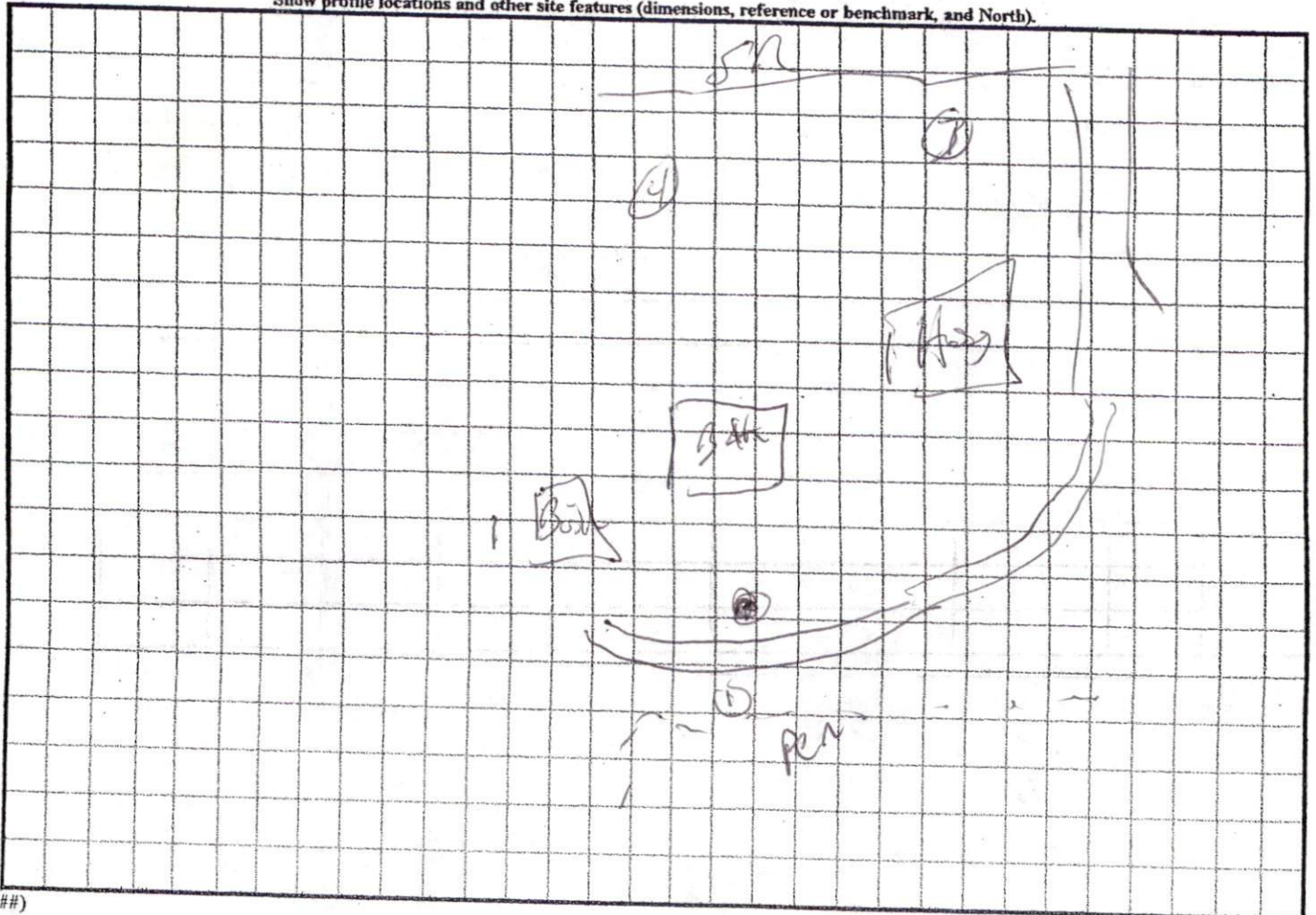

5' x 5' 0"
25' x 4' 0"
1000 sq ft
18-24"

